



22 Lavender Road, Gaywood, King's Lynn, PE30 4HA

£245,000

2 1 2



Set just off Wootton Road and within walking distance of the amenities in Gaywood, you will find this detached bungalow which is available to the market with no onward chain. The bungalow has private parking and south facing rear garden and is believed to have originally been built as a 3 bedroom property.





Key Features

- Detached bungalow
- 2 Reception areas
- 24ft Lounge
- Car port
- No chain
- 2 Double bedrooms
- Conservatory
- South facing garden
- Boot room
- Close to amenities

GROUND FLOOR
1175 sq.ft. (109.1 sq.m.) approx.

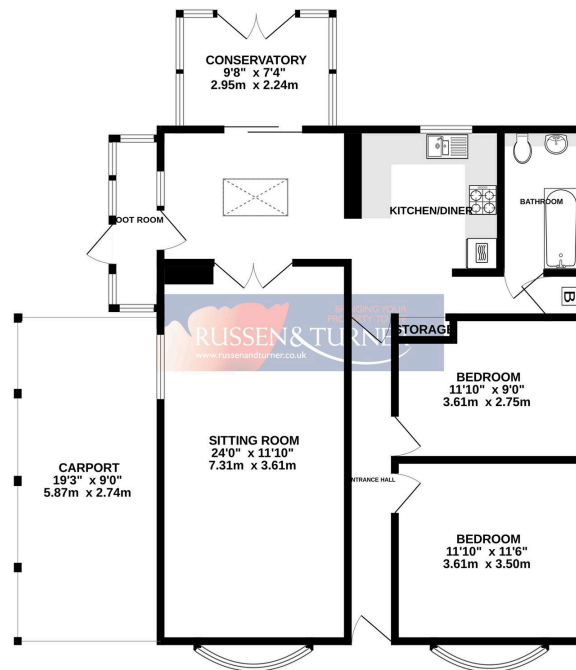

TOTAL FLOOR AREA: 1175 sq.ft. (109.1 sq.m.) approx.
Whilst every attempt has been made to ensure the accuracy of the floorplan contained herein, measurements of doors, windows, rooms and any other items are approximate and no responsibility is taken for any errors, omissions or mis-statements. This plan is for illustrative purposes only and should be used as such by any prospective purchaser. The services, systems and appliances shown have not been tested and no guarantee as to their operability or efficiency can be given.
Made with Metropex ©2024

