



## 36 Lynn Road, King's Lynn PE30 4PX

£210,000

3 1 2



Calling all investors or First Time Buyers!! Offered to the market with no onward chain, this generously proportioned, semi-detached home offers a wealth of bright and airy accommodation, off-road parking, and a larger than average rear garden along with a wealth of amenities right on it's doorstep.





## Key Features

- Semi-detached House
- Three Bedrooms
- Superb Investment Opportunity
- Two Reception Rooms
- Private Rear Garden
- Off-road Parking
- Ideal First Home
- Gas Central Heating
- Fantastic Location - Local Amenities on your Doorstep
- No Onward Chain

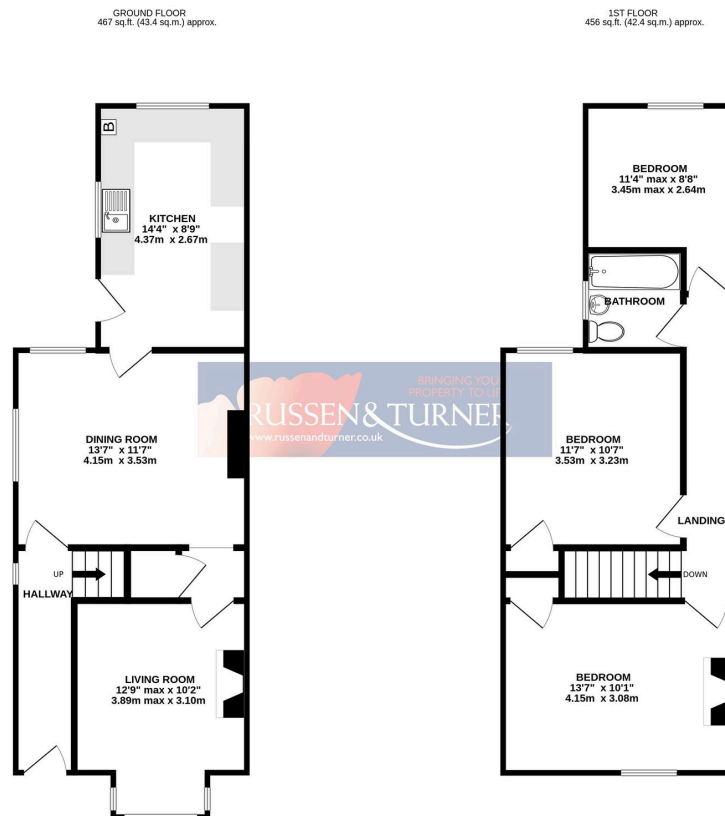

TOTAL FLOOR AREA: 923 sq.ft. (85.8 sq.m.) approx.

Whilst every attempt has been made to ensure the accuracy of the floorplan contained here, measurements of doors, windows, rooms and any other items are approximate and no responsibility is taken for any error, omission or mis-statement. This plan is for illustrative purposes only and should be used as such by any prospective purchaser. The services, systems and appliances shown have not been tested and no guarantee as to their operation or efficiency can be given.  
Made with Metropix 10/2024

