



69 Suffield Way, King's Lynn PE30 3DX

£210,000

3 1 1



PERFECT FIRST HOME! Looking for a house that you can make your own? If you are, this generously proportioned, semi-detached house in the much sought after 'Grange' area of King's Lynn could be the one for you. With no onward chain, a south facing garden, garage and off-road parking it has almost everything you could need.





Key Features

- Semi-Detached House
- South Facing Garden
- Perfect First or Family Home
- Garage and Off-road Parking
- Modern Kitchen
- Three Bedrooms
- No Onward Chain
- Put your stamp on this property
- Gas Central Heating
- Bright and Airy 20ft Living/Dining Room

GROUND FLOOR
503 sq.ft. (46.8 sq.m.) approx.

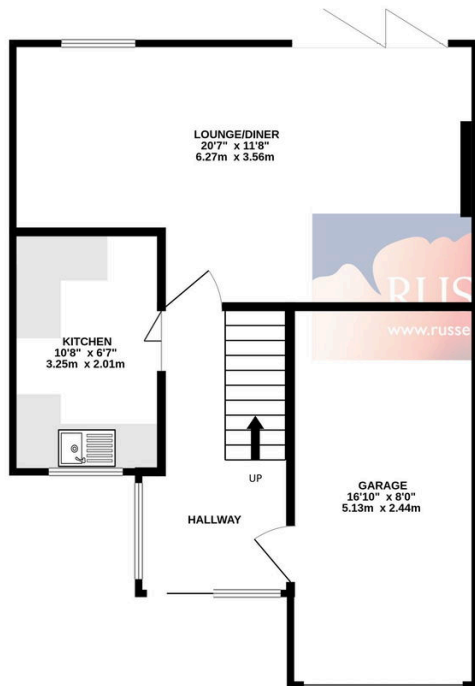

1ST FLOOR
391 sq.ft. (36.3 sq.m.) approx.

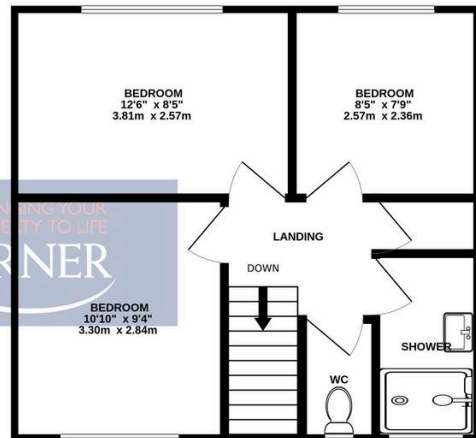

TOTAL FLOOR AREA : 895 sq.ft. (83.1 sq.m.) approx.

Whilst every attempt has been made to ensure the accuracy of the floorplan contained here, measurements of doors, windows, rooms and any other items are approximate and no responsibility is taken for any error, omission or mis-statement. This plan is for illustrative purposes only and should be used as such by any prospective purchaser. The services, systems and appliances shown have not been tested and no guarantee as to their operability or efficiency can be given.
Made with Metropix ©2024

