



31 Winfarthing Avenue, King's Lynn PE30 5LY

Offers Over £184,995

🛏 3 🚗 1 🚲 1



RUSSEN & TURNER
www.russenandturner.co.uk



Bright & spacious kitchen / dining room



Located less than a mile walk from King's Lynn town centre and the train station is this delightful, 3 bedroom, end terrace home. The house overlooks the playground to the front and offers family accommodation with gas central heating and double glazing throughout.



Key Features

- End-terrace house
- 16ft Kitchen / dining room
- Gas central heating
- Close to amenities
- Front & rear garden
- 3 Bedrooms
- Ground floor W.C.
- Double glazed
- Overlooks park
- Ideal 1st time home

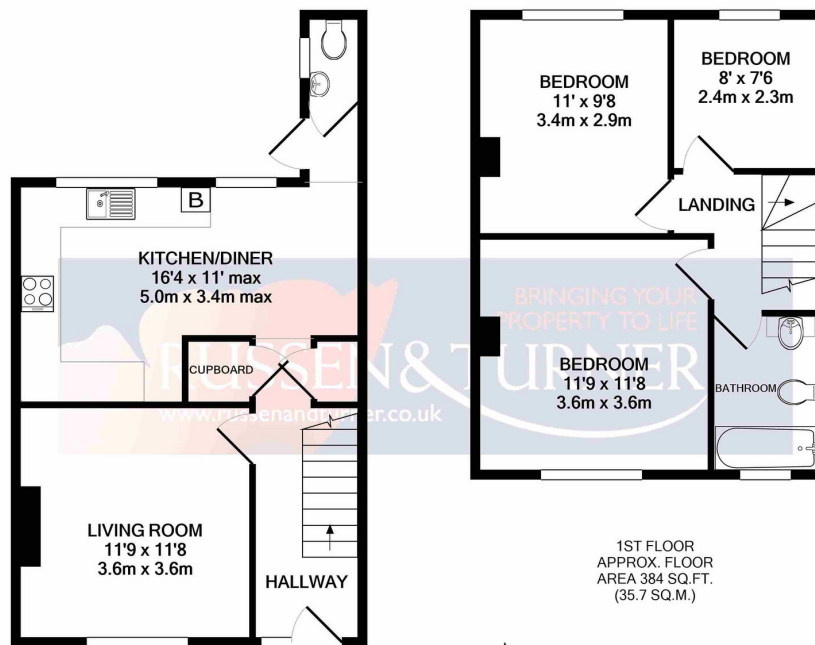

TOTAL APPROX. FLOOR AREA 792 SQ.FT. (73.5 SQ.M.)

Whilst every attempt has been made to ensure the accuracy of the floor plan contained here, measurements of doors, windows, rooms and any other items are approximate and no responsibility is taken for any error, omission, or mis-statement. This plan is for illustrative purposes only and should be used as such by any prospective purchaser. The services, systems and appliances shown have not been tested and no guarantee as to their operability or efficiency can be given
Made with Metropix ©2020

