



12 St Peters Close, West Lynn PE34 3JX

£190,000

 2  1  2



PRIVATE GARDEN & RIVER VIEWS! A short walk from the heart of the village, this generously proportioned, bright and airy, two double bedroom, detached bungalow perfectly combines the peace of rural living with the convenience of having amenities close by.





Key Features

- Detached Bungalow
- Two Reception Rooms
- Gas Central Heating
- Main Bedroom with Dressing Room
- Short Walk to Heart of Village
- Two Double Bedrooms
- Private Rear Garden with River Views
- Off-road Parking and Carport
- Bright and Airy Accommodation
- Potential to Improve

GROUND FLOOR
810 sq.ft. (75.3 sq.m.) approx.

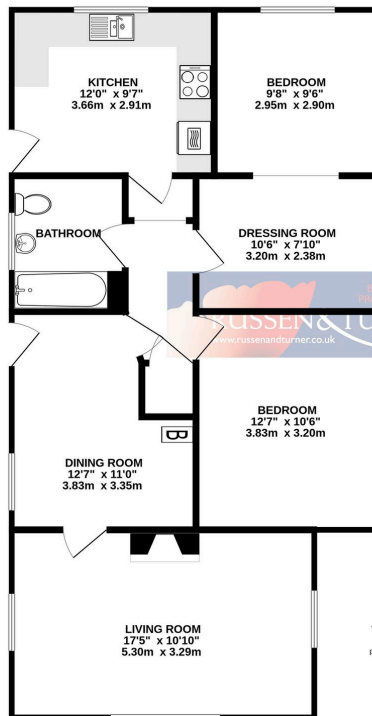

TOTAL FLOOR AREA: 810 sq.ft. (75.3 sq.m.) approx.

Whilst every attempt has been made to ensure the accuracy of the floorplan contained here, measurements of doors, windows, rooms and any other items are approximate and no responsibility is taken for any error, omission or mis-statement. This plan is for illustrative purposes only and should be used as such by any prospective purchaser. The services, systems and appliances shown have not been tested and no guarantee as to their operability or efficiency can be given.
Made with Metropix iC204

