



## 40 Sir Lewis Street, King's Lynn PE30 2AH

£149,995

3 1 2



A much improved turn of the century home which has been well-maintained by the owner who has added a new kitchen, bathroom, heating and much more. Ideal for the 1st time buyer or an investor looking for a turn-key property within walking distance of the town centre and all its excellent amenities.





## Key Features

- Terraced house
- 2 Reception rooms
- Double glazed
- Close to amenities
- Ideal 1st time buy
- 3 Bedrooms
- Gas central heating
- Much improved by current owner
- Band A
- Less than a mile from train station

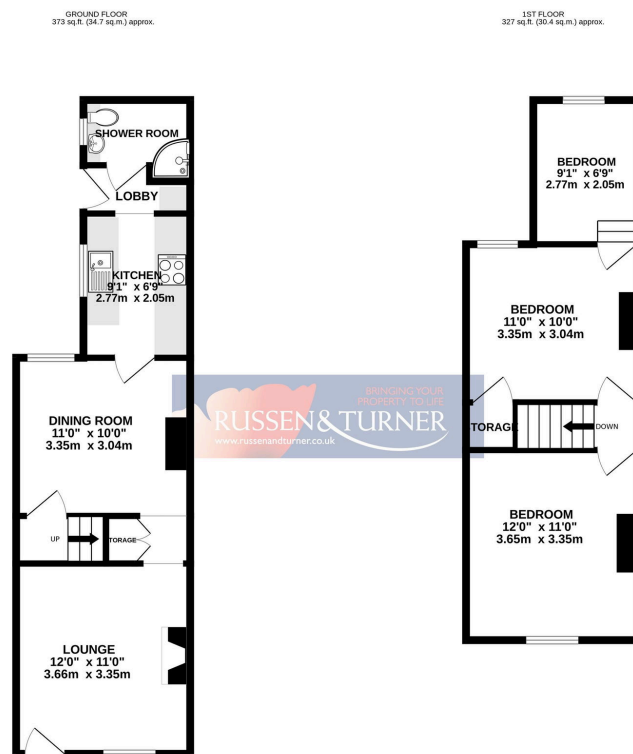

TOTAL FLOOR AREA: 700 sq ft. (65.1 sq.m.) approx.

Whilst every effort has been made to ensure the accuracy of the description contained herein, measurements of doors, windows, rooms and any other items are approximate and no responsibility is taken for any error, omission or mis-statement. This plan is for illustrative purposes only and should be used as such by any prospective purchaser. The services, systems and appliances shown have not been tested and no guarantee as to their operability or efficiency can be given.  
Made with Metropix ©2024

