

44 Wingfield, King's Lynn PE30 4XG

£189,995

 3  1  1



PERFECT FIRST HOME! Within walking distance of the Queen Elizabeth Hospital, this three bedroom mid terraced house has recently undergone a full renovation. The perfect first home, it's stunning accommodation and gardens mean you simply turn the key, move your furniture in and enjoy your new home.

Key Features

- Mid Terraced House
- Immaculate Presentation - Recently Updated
- Gas Central Heating
- Ideal First Home
- Private, Low Maintenance Rear Garden
- Three Bedrooms
- Close to Queen Elizabeth Hospital
- Sought After Location
- Move in Ready
- Bright and Airy Accommodation

GROUND FLOOR
403 sq.ft. (37.5 sq.m.) approx.

1ST FLOOR
404 sq.ft. (37.5 sq.m.) approx.

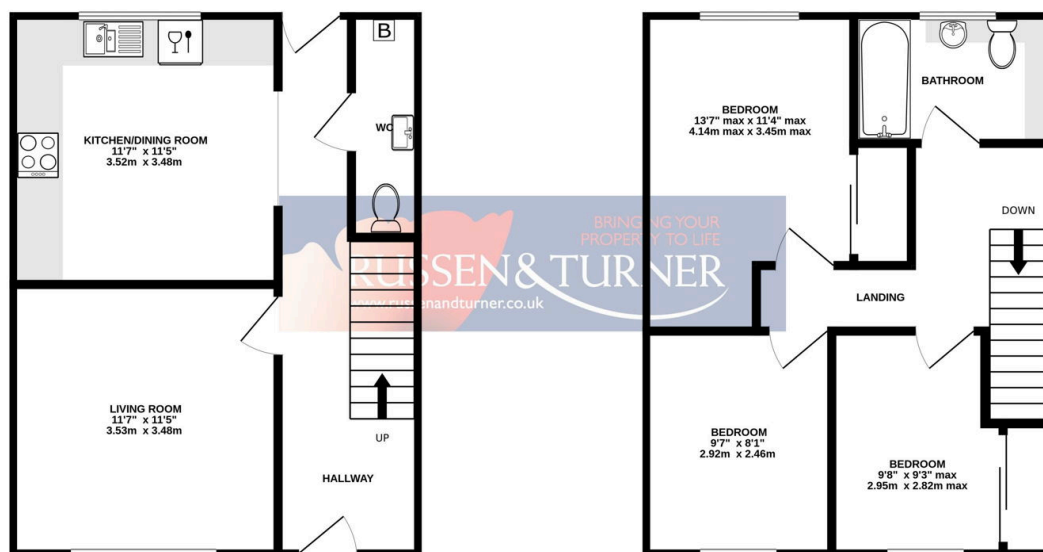

TOTAL FLOOR AREA : 807 sq.ft. (75.0 sq.m.) approx.

Whilst every attempt has been made to ensure the accuracy of the floorplan contained here, measurements of doors, windows, rooms and any other items are approximate and no responsibility is taken for any error, omission or mis-statement. This plan is for illustrative purposes only and should be used as such by any prospective purchaser. The services, systems and appliances shown have not been tested and no guarantee as to their operability or efficiency can be given.

Made with Metropix 62024