



63 Methuen Avenue, King's Lynn PE30 4BW

Offers Over £175,000

 3  1  2



Looking for a house to add value to? Set just off the popular Wootton Road is this 3 bedroom, terraced property which is available to the market with no onward chain. The house has gas central heating and is double glazed and could be the ideal first time buy.





Key Features

- Terraced house
- 3 Bedrooms
- Front & rear gardens
- Double glazed
- Ground floor W.C.
- Bay fronted
- 2 Receptions
- Gas central heating
- Utility
- No chain

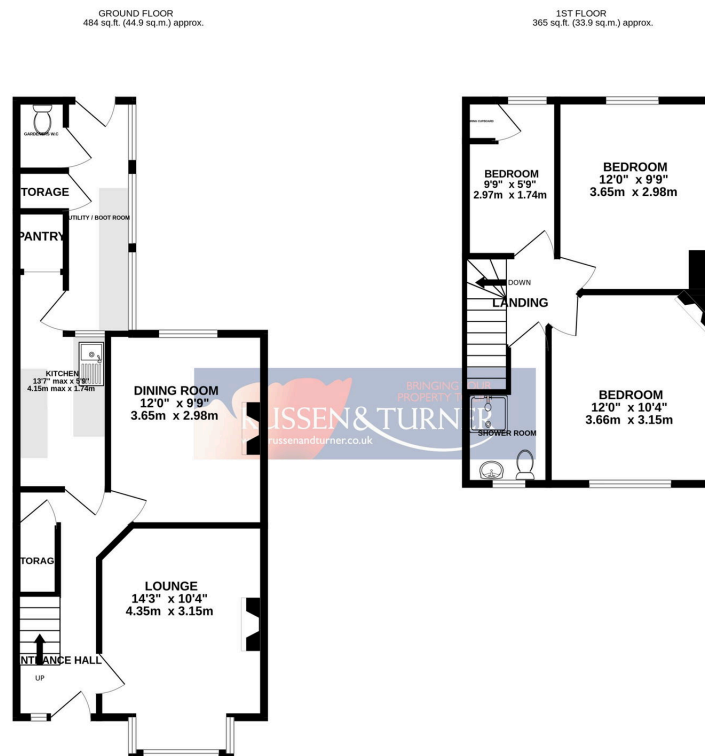

TOTAL FLOOR AREA: 849 sq.ft. (78.9 sq.m.) approx.
 Whilst every attempt has been made to ensure the accuracy of the description contained here, measurements of doors, windows, rooms and any other items, are approximate and no responsibility is taken for any error, omission or misstatement. This plan is for illustrative purposes only and should be used as such by any prospective purchaser. The services, systems and appliances shown have not been tested and no guarantee is given as to their operability or efficiency on the given.
 Made with Metropix ©2024

