

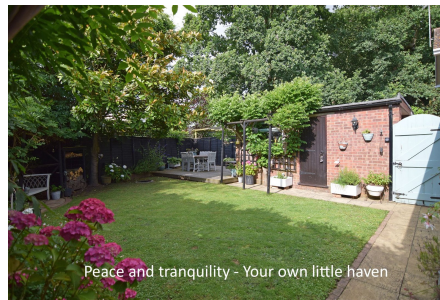

35 Temple Road, King's Lynn PE30 3SQ

£315,000

3 1 2



Possibly the most exquisite house on the street. Boasting picturesque woodland walks from it's doorstep, this stunning home is perfect for those that love to entertain. Whether inside or out this detached home offers one of the most stunning finishes we may have ever seen.





Key Features

- Detached House
- Exquisite Presentation
- Perfect Family Home
- Superb Home for Entertaining
- Move in Ready
- Three Bedrooms
- Woodland Walks on your doorstep
- Private Rear Garden
- Garage and Off-road Parking
- Close to Local Amenities - Schools, Shops and More

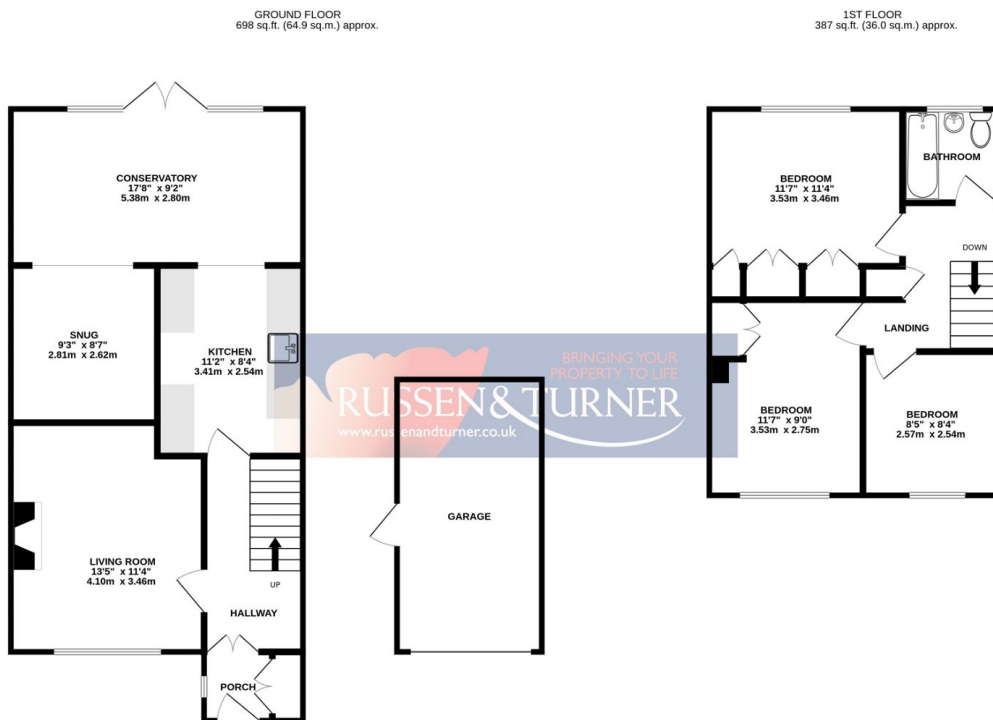

TOTAL FLOOR AREA : 1085 sq.ft. (100.8 sq.m.) approx.

Whilst every attempt has been made to ensure the accuracy of the floorplan contained here, measurements of doors, windows, rooms and any other items are approximate and no responsibility is taken for any error, omission or mis-statement. This plan is for illustrative purposes only and should be used as such by any prospective purchaser. The services, systems and appliances shown have not been tested and no guarantee as to their operability or efficiency can be given.
Made with Metropix ©2024

