



13 Bentinck Way, West Lynn PE34 3LZ

£239,995

3 1 1



Set down a quiet cul-de-sac and enjoying open, westerly, views across the Norfolk countryside sits this delightful, detached bungalow. The property has a fabulous garden-room overlooking the rear garden as well as private parking and a detached garage. There is gas central heating and PVCu double glazing and the bungalow is for sale with no onward chain.





Key Features

- Detached bungalow
- Fabulous garden room
- Private parking
- Cul-de-sac
- PVCu double glazed
- 3 Bedrooms
- Detached garage
- Westerly facing garden
- No chain
- Band B tax

GROUND FLOOR
971 sq.ft. (90.2 sq.m.) approx.

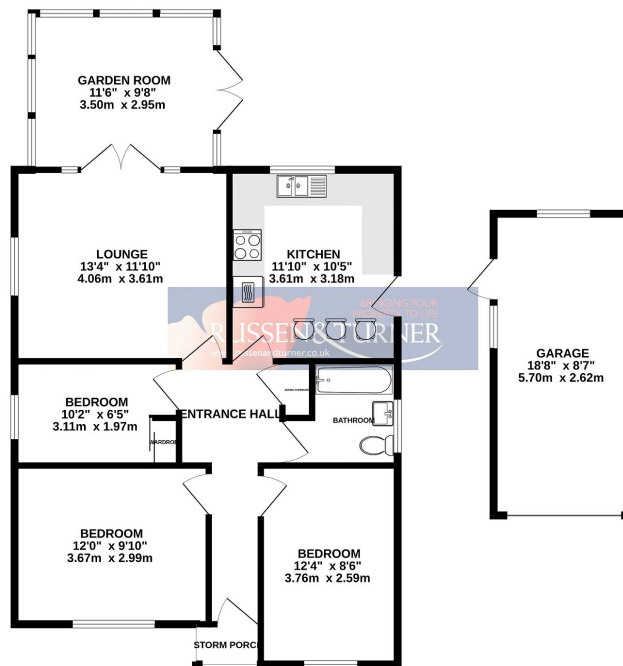

TOTAL FLOOR AREA: 971 sq ft (90.2 sq.m.) approx.
 Whilst every attempt has been made to ensure the accuracy of the figures contained herein, measurements of doors, windows, rooms and any other items are approximate and no responsibility is taken for any error, omission or mis-statement. This plan is for illustrative purposes only and should be used as such by any prospective purchaser. The services, systems and appliances shown have not been tested and no guarantee as to their operability or efficiency can be given.
 Made with Metropix 02024

