



# RUSSEN & TURNER

www.russenandturner.co.uk

COMMERCIAL PROPERTY SURVEYORS & VALUERS  
BUILDING & PARTY WALL SURVEYORS  
ARCHITECTURAL DESIGNERS  
**ESTATE AGENTS**

## 350 Wootton Road, King's Lynn PE30 3EB

£365,000

 4  1  2

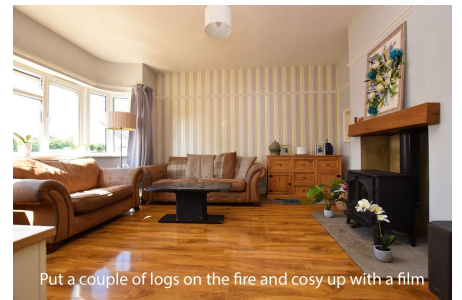

Family sized homes on Wootton Road always attract good interest due to their close proximity to the town and the amenities of of Gaywood. This large, semi-detached, period house should be no exception as it has had a great deal of work carried out since the current owners moved in in 2017. There is ample parking for several vehicles and a large garden which boasts a detached garage and a fabulous outside bar / entertainment area.





## Key Features

- Semi-detached house
- Bathroom and separate W.C.
- 20ft Kitchen / breakfast room
- Outdoor bar
- Popular location
- 4 Bedrooms
- 2 Reception rooms
- Large detached garage
- Generous plot
- No chain

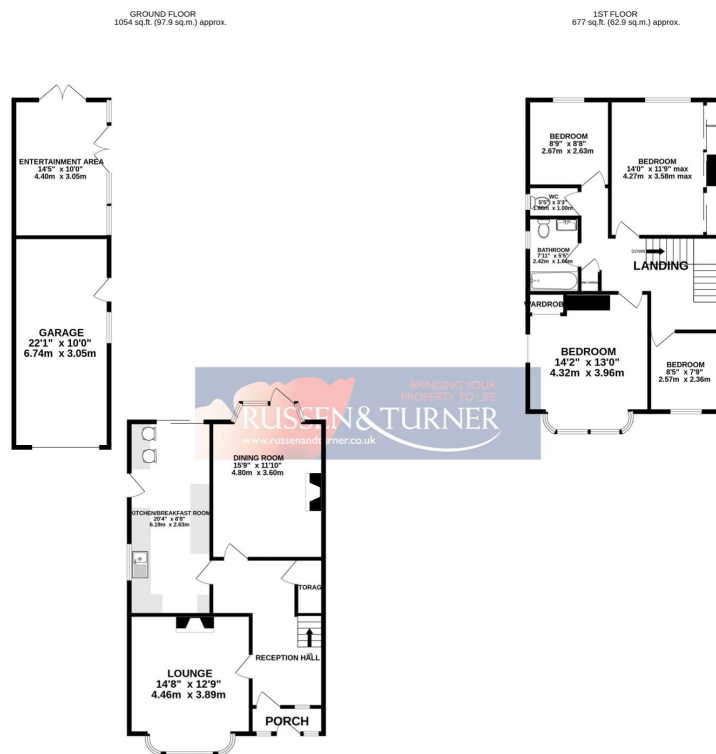

TOTAL FLOOR AREA: 1730 sq.ft. (160.7 sq.m.) approx.

While every effort has been made to ensure the accuracy of the floorplans contained herein, measurements of doors, windows, rooms and any other items are approximate and no responsibility is taken for any error, omission or mis-statement. This plan is for illustrative purposes only and should be used as such by any prospective purchaser. The services, systems and appliances shown have not been tested and no guarantee as to their operability or efficiency can be given.  
Made with Metronix i2024

