

**26 Parkway, King's Lynn PE30 4PE**

**£185,000**

 2  1  1



A gardeners delight. If you enjoy gardening and are looking for a bungalow close to the amenities of Gaywood, then we have what you're looking for. Available with no onward chain and competitively priced, is this semi-detached home which can be enjoyed as it is, or extended to offer further accommodation (subject to relevant permissions).

## Key Features

- Semi-detached bungalow
- 2 Double bedrooms
- Shower room
- Large plot
- Double glazed
- Oil central heating
- No chain
- Close to amenities
- Potential to extend
- Tax band A

## GROUND FLOOR 622 sq.ft. (57.7 sq.m.) approx.

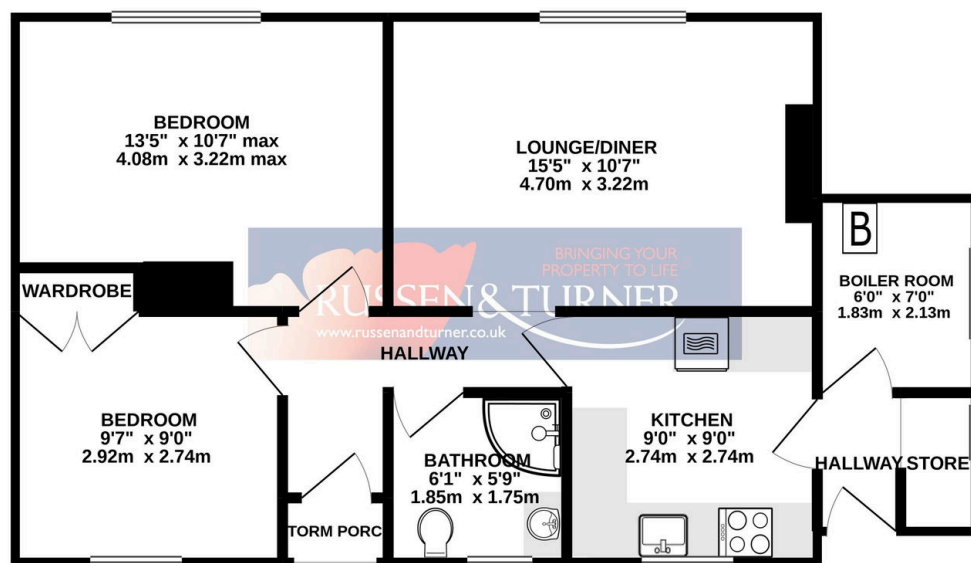

TOTAL FLOOR AREA : 622 sq.ft. (57.7 sq.m.) approx.

Whilst every attempt has been made to ensure the accuracy of the floorplan contained here, measurements of doors, windows, rooms and any other items are approximate and no responsibility is taken for any error, omission or mis-statement. This plan is for illustrative purposes only and should be used as such by any prospective purchaser. The services, systems and appliances shown have not been tested and no guarantee as to their operability or efficiency can be given.

Made with Metropix ©2021

