

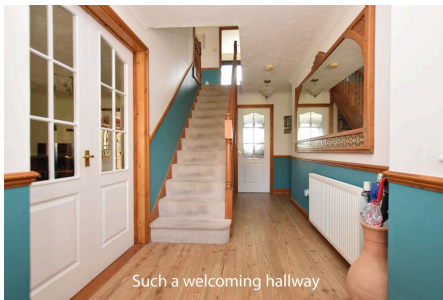

11 Shepherds Fold, Swaffham, PE37 7TR

£350,000

4 2 4



Looking for a family home which offers potential for multi-generational living? Or do you need some separate space for your growing family? This house has undergone a well-thought-out conversion which means this generously sized, family home boasts 4 double bedrooms, 4 reception rooms & a conservatory, as well as 2 bathrooms and a ground floor W.C.



Key Features

- Detached family home
- 4 Bedrooms
- 4 Receptions
- Conservatory
- Garage
- Ensuite
- Utility
- Ground floor W.C.
- Field views to rear
- Cul-de-sac position

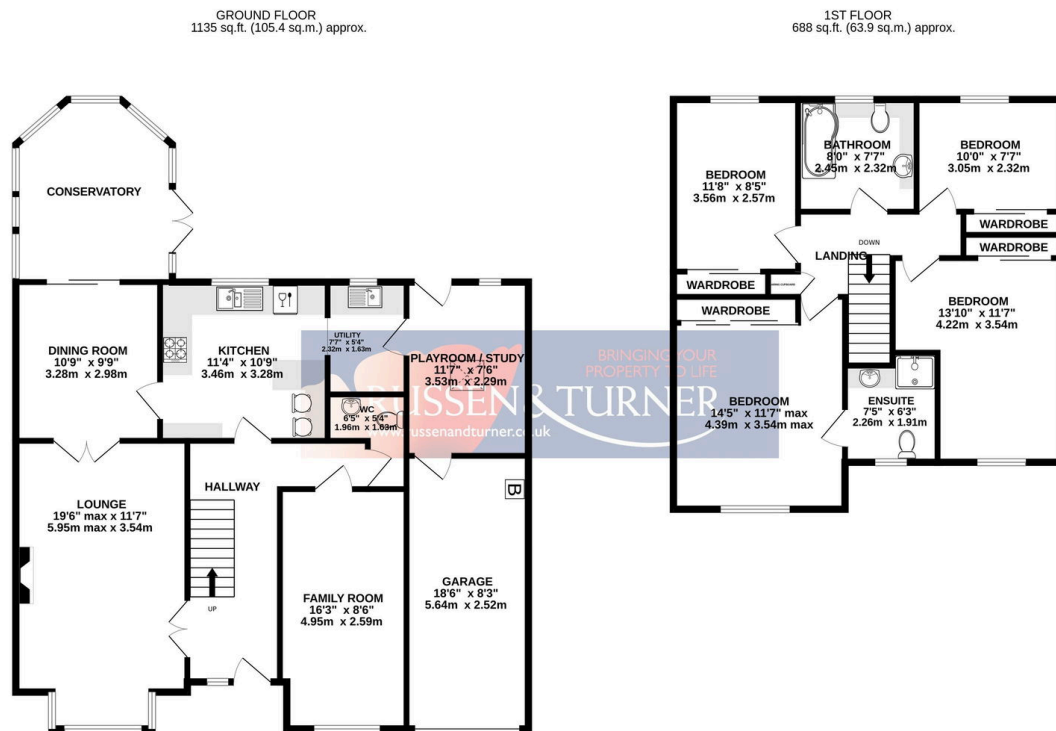

TOTAL FLOOR AREA : 1823 sq.ft. (169.3 sq.m.) approx.

Whilst every attempt has been made to ensure the accuracy of the floorplan contained here, measurements of doors, windows, rooms and any other items are approximate and no responsibility is taken for any error, omission or mis-statement. This plan is for illustrative purposes only and should be used as such by any prospective purchaser. The services, systems and appliances shown have not been tested and no guarantee as to their operability or efficiency can be given.
Made with Metropix ©2024

