



## 24 Orchard Way, Terrington St John PE14 7TD

Offers Over £270,000

4 2 2



**SPACE, SPACE AND MORE SPACE!** Need a home that offers a bit more? This extended, four bedroom, semi-detached home is the one for you. Close to the heart of the village and all its amenities, this fabulous, versatile home offers all the space and more that you and your family could need.





## Key Features

- Semi-Detached House
- Extended Family Home - Flexible Accommodation
- Close to Village Amenities
- Superb Room Proportions Throughout
- Garage/Workshop
- Four Bedrooms
- Private Rear Garden
- Off-road Parking
- Two Bathrooms
- Move in Ready

GROUND FLOOR  
898 sq.ft. (83.4 sq.m.) approx.

1ST FLOOR  
762 sq.ft. (70.8 sq.m.) approx.

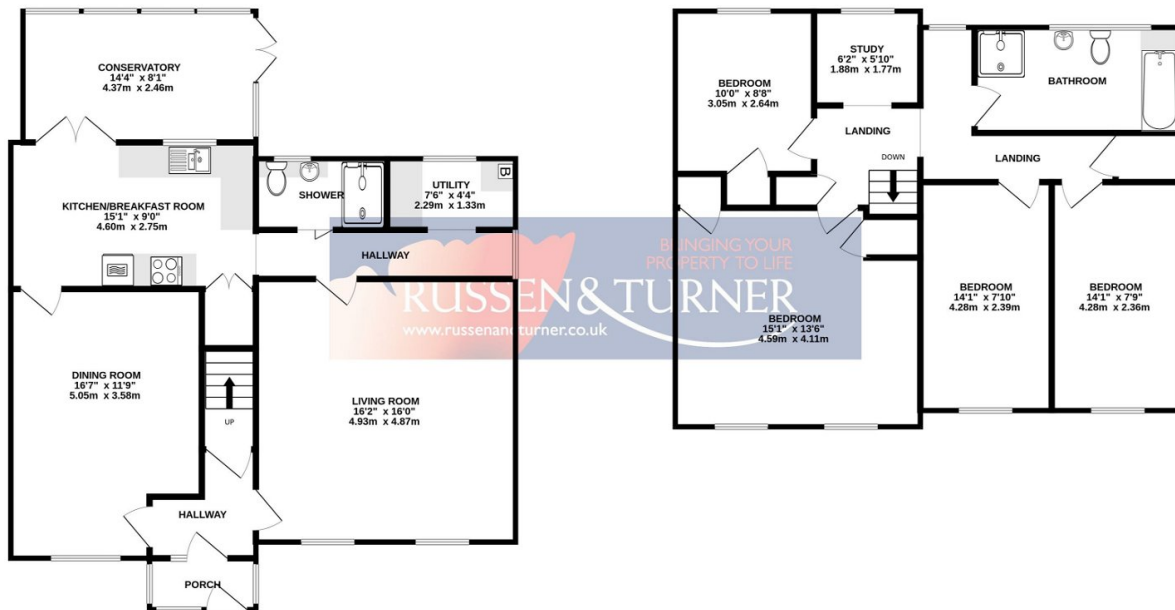

TOTAL FLOOR AREA: 1660 sq.ft. (154.2 sq.m.) approx.

Whilst every attempt has been made to ensure the accuracy of the floorplan contained here, measurements of doors, windows, rooms and any other items are approximate and no responsibility is taken for any error, omission or mis-statement. This plan is for illustrative purposes only and should be used as such by any prospective purchaser. The services, systems and appliances shown have not been tested and no guarantee as to their operability or efficiency can be given.

Made with Metropix ©2024

