

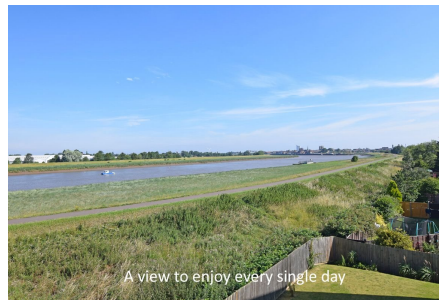

100f Coopers Court, Wisbech Road, King's Lynn PE30 5LJ

£125,000

 2  1  1



STUNNING RIVERSIDE VIEWS!! Situated a short, riverside stroll from the town centre and picturesque quay front, is this contemporary, second floor, apartment. A fantastic first home or potential investment opportunity, the stylish accommodation perfectly complements the delightful views that you can enjoy





Key Features

- Second Floor Apartment
- Stylish Presentation
- Resident's Parking
- Long Lease - Over 900 Years
- Distant Views of the Town and Historic Quay
- Two Double Bedrooms
- Overlooking the River
- Contemporary Open Plan Living/Kitchen/ Dining Room
- Ideally Situated - Within Walking Distance of the Town Centre
- Ideal First Home or Potential Investment Opportunity

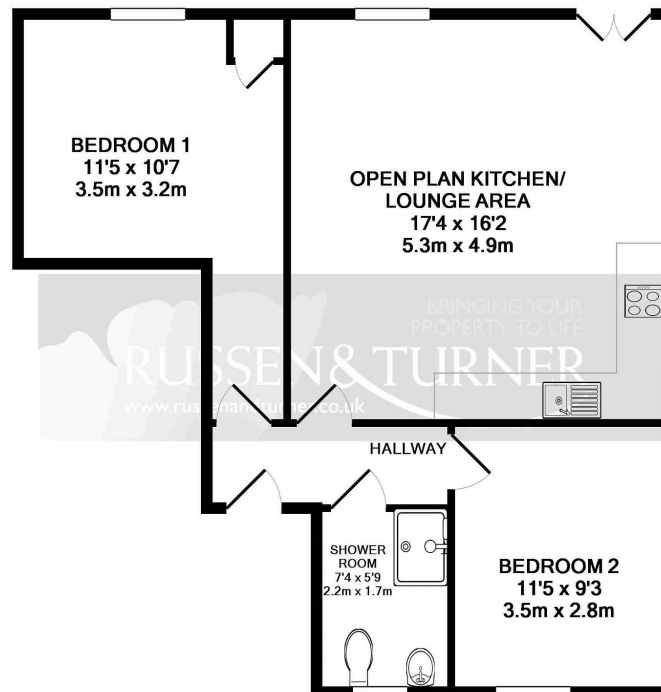

Whilst every attempt has been made to ensure the accuracy of the floor plan contained here, measurements of doors, windows, rooms and any other items are approximate and no responsibility is taken for any error, omission, or mis-statement. This plan is for illustrative purposes only and should be used as such by any prospective purchaser. The services, systems and appliances shown have not been tested and no guarantee as to their operability or efficiency can be given
Made with Metropix ©2017

