





## 29 Goodwins Road, King's Lynn PE30 5QX

£395,000

 4  2  2



Looking for a large, family home with a private garden that's perfect for entertaining but still want the convenience of living close to town and the train station? This delightful town-house has been beautifully updated by the current owners to offer highly versatile accommodation which is set over 3 floors. With 3 / 4 bedrooms, 2 bathrooms, 2 kitchens, parking and a garage, this generously sized home should tick all your boxes including the boxes you didn't know you needed ticking.





## Key Features

- Semi-detached family home
- 3 / 4 Bedrooms
- 2 Kitchens
- Entertainment space
- Close to town centre
- 3 Storey Town House
- 30ft+ 'Living-Kitchen'
- Versatile accommodation
- Garage
- Desirable location

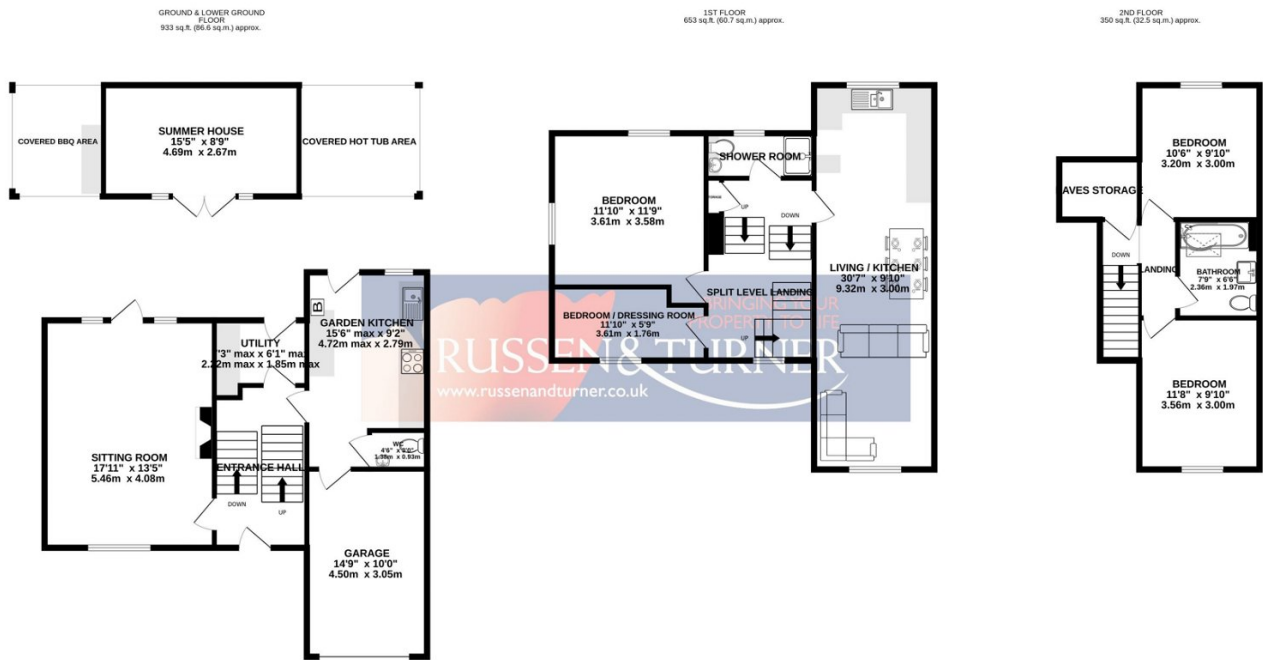

TOTAL FLOOR AREA: 1935 sq.ft. (179.8 sq.m.) approx.

Whilst every attempt has been made to ensure the accuracy of the floorplan contained here, measurements of doors, windows, rooms and any other items are approximate and no responsibility is taken for any error, omission or mis-statement. This plan is for illustrative purposes only and should be used as such by any prospective purchaser. The services, systems and appliances shown have not been tested and no guarantee as to their operability or efficiency can be given.

Made with Metropix ©2024

