



The Spinney, 100 Main Road, West Winch PE33 0LW

£425,000

4 3 3



Looking for somewhere with potential for multi-generational living? This large, extended, chalet-bungalow offers incredibly versatile accommodation which is set over 2 floors and boasts a large plot of approximately 1/4 of an acre with views across open farmland. With 4 / 5 bedrooms, 3 receptions, 3 bath/shower rooms and much more in terms of living space, the only problem you may find, is deciding how you'll use each of the fabulous rooms.





Key Features

- Detached chalet-bungalow
- 3 Bath/shower rooms
- Quarter acre plot (sts)
- Ample parking
- Multi-generational living
- 4 / 5 Bedrooms
- 3 Receptions
- Refurbished and extended by current owners
- Field views
- Great for entertaining

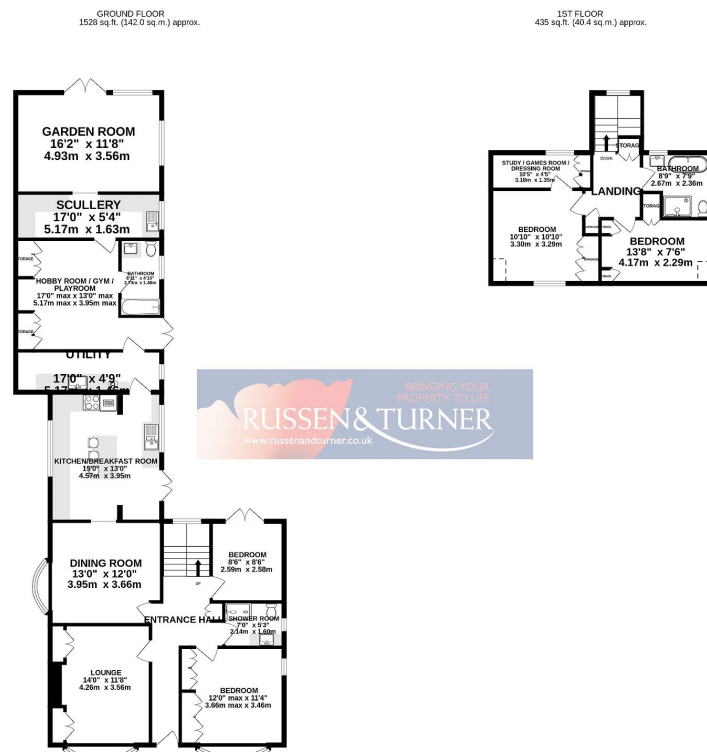

TOTAL FLOOR AREA: 1963 sq. ft. (182.4 sq.m.) approx.
 Whilst every attempt has been made to ensure the accuracy of the figures contained herein, measurements of doors, windows, rooms and any other items are approximate and no responsibility is taken for any error, omission or mis-statement. The plan is for illustrative purposes only and should be used as such for any prospective purchase. The services, systems and appliances shown have not been tested and no guarantee as to their operability or efficiency can be given.
 Made with MetreXp 12/2021

