



2 Elmhurst Drive, South Wootton PE30 3LA

£395,000

3 1 1



A gardener's dream...privacy, well-stocked, beautifully tended & south facing. This delightful, detached bungalow is tucked away in a quiet spot just off Nursery Lane and is set a mere stone's throw from the village green and the popular village restaurant called the Swan. There are 3 double bedrooms, and a large lounge and kitchen / breakfast room along with a contemporary shower room as well as a separate W.C. Properties here rarely come to the market and always command high levels interest, so please call early to book your appointment.





Key Features

- Detached bungalow
- 25ft Lounge
- Utility
- Converted garage
- Stunning gardens
- 3 Double bedrooms
- Contemporary shower room
- South facing
- Desirable location
- No chain

GROUND FLOOR
1295 sq.ft. (120.3 sq.m.) approx.

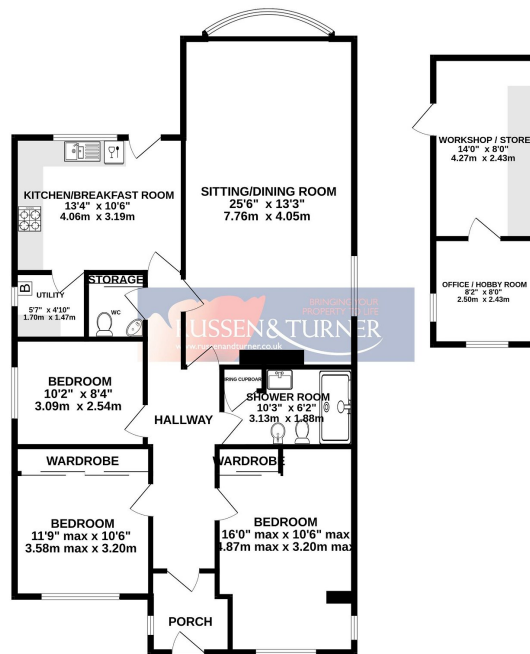

TOTAL FLOOR AREA: 1295 sq.ft. (120.3 sq.m.) approx.
 Whilst every attempt has been made to ensure the accuracy of the floorplan contained here, measurements of doors, windows, rooms and any other items are approximate and no responsibility is taken for any error, omission or mis-statement. This plan is for illustrative purposes only and should be used as such by any prospective purchaser. The services, systems and appliances shown have not been tested and no guarantee as to their operability or efficiency can be given.
 Made with Metropac C0204

