



4 Wilton Crescent, North Wootton PE30 3RB

£340,000

4 1 2



Looking for your next family home? Perhaps a property that you can put your own stamp on and really make your own? Tucked away in a cul-de-sac, on a deceptively large corner plot, in the highly desirable and much sought after village of North Wootton, this versatile three/four bed, detached, family home could be the one you've been searching for.





Key Features

- Detached House
- Versatile Accommodation
- No Onward Chain
- Set Within a Cul-de-sac on a Stunning Corner Plot
- Private Rear Garden
- Three/Four Bedrooms
- Two/Three Reception Rooms
- Sought After Location
- Gas Central Heating
- Off-road Parking, Car port and Garage

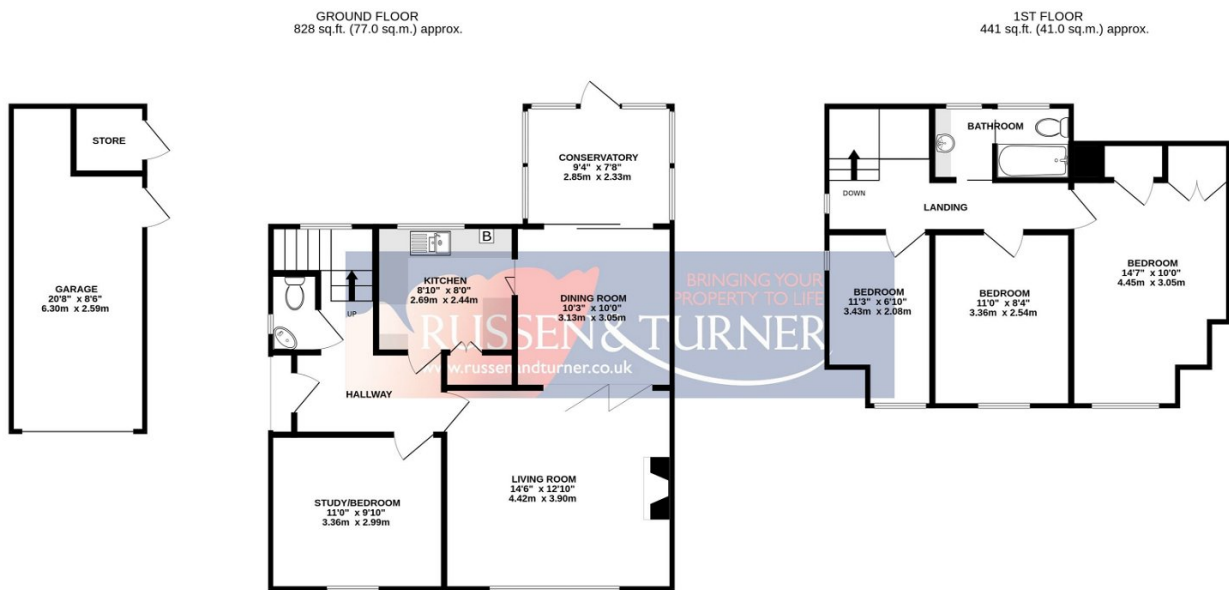

TOTAL FLOOR AREA: 1269 sq.ft. (117.9 sq.m.) approx.

Whilst every attempt has been made to ensure the accuracy of the floorplan contained here, measurements of doors, windows, rooms and any other items are approximate and no responsibility is taken for any error, omission or mis-statement. This plan is for illustrative purposes only and should be used as such by any prospective purchaser. The services, systems and appliances shown have not been tested and no guarantee as to their operability or efficiency can be given.
Made with Metropix ©2024

