



64 Suffield Way, King's Lynn PE30 3DL

£225,000

 4  1  2



SOUGHT AFTER LOCATION! Nestled in the highly sought after 'Grange' area of King's Lynn is this fantastically versatile, three/four bedroom family home. It boasts a wealth of flexible accommodation, a fabulously private rear garden, garage and off-road parking making it a perfect family home.





Key Features

- Semi-Detached House
- Two/Three Reception Rooms
- Private Rear Garden
- Popular Location - Close to Local Amenities
- Gas Central Heating
- Three/Four Bedrooms
- Versatile Accommodation
- Garage
- Off-road Parking
- Superb Home for Entertaining

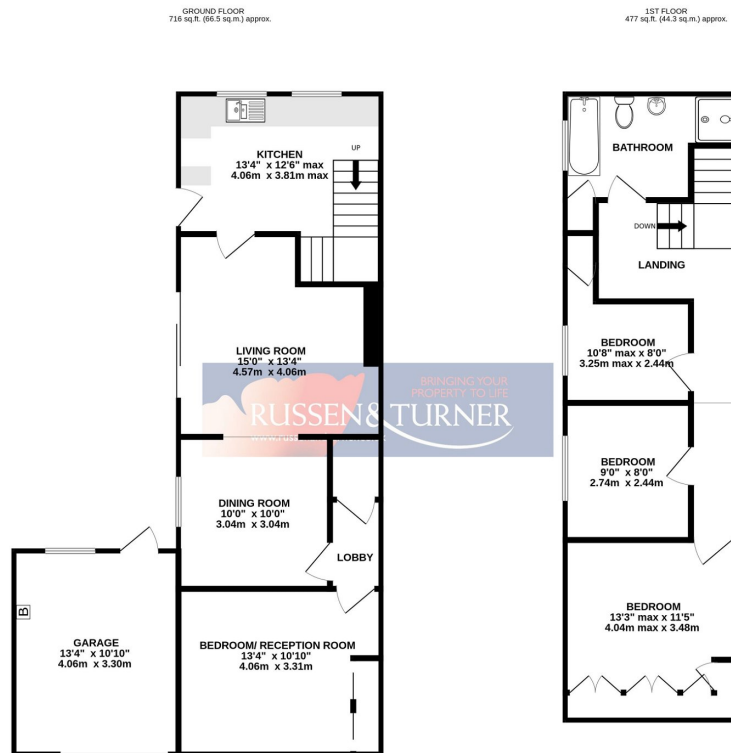

TOTAL FLOOR AREA - 1193 sq ft. (110.8 sq.m.) approx.

Whilst every attempt has been made to ensure the accuracy of the description contained herein, measurements of doors, windows, rooms and any other items are approximate and no responsibility is taken for any error, omission or mis-statement. This plan is for illustrative purposes only and should be used as such by any prospective purchaser. The services, systems and appliances shown have not been tested and no guarantee as to their operability or efficiency can be given.
Made with Metropix ©2024

