



## 14 The Courtyard, Snettisham PE31 7XA

Guide Price £250,000

3 1 1



**Oh we do love to be beside the seaside?** Set in a pretty conservation area in the picturesque village of Snettisham, just a few miles inland from Norfolk's beautiful coast, is this delightful 'gingerbread' cottage. The property is within walking distance of local pubs, shops and restaurants so would make an ideal home for the family or use as a holiday home. There is allocated parking to the rear and a generous courtyard garden which is low-maintenance and offers enough space for family and friends.





## Key Features

- Carrstone cottage
- Private courtyard
- Less than 3 miles to the beach
- Grade II listed
- Conservation area
- 3 Bedooms
- Allocated parking
- No onward chain
- Beautiful village
- Walking distance of amenities

GROUND FLOOR  
425 sq.ft. (39.5 sq.m.) approx.

1ST FLOOR  
394 sq.ft. (36.6 sq.m.) approx.

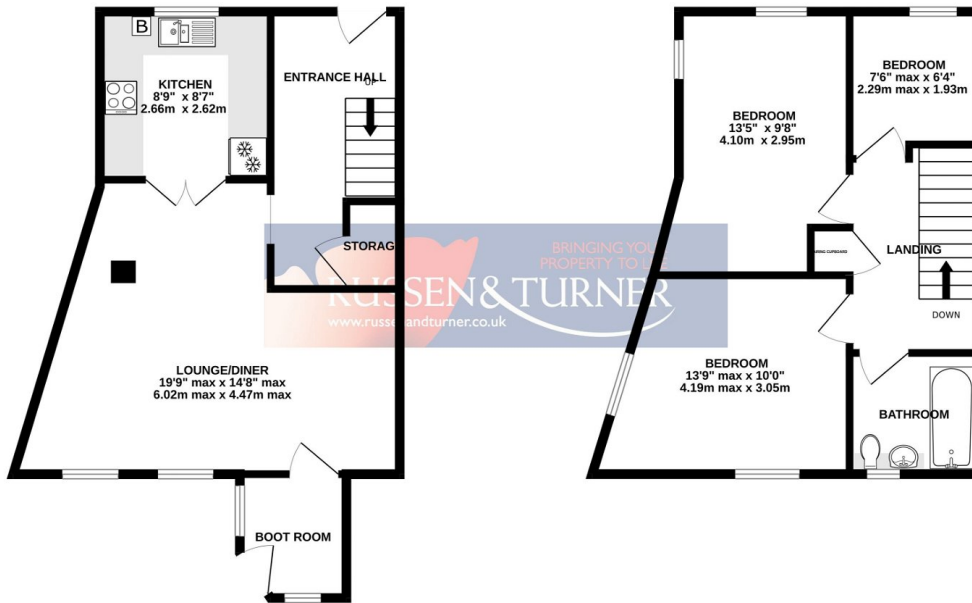

TOTAL FLOOR AREA : 819 sq.ft. (76.1 sq.m.) approx.

Whilst every attempt has been made to ensure the accuracy of the floorplan contained here, measurements of doors, windows, rooms and any other items are approximate and no responsibility is taken for any error, omission or mis-statement. This plan is for illustrative purposes only and should be used as such by any prospective purchaser. The services, systems and appliances shown have not been tested and no guarantee as to their operability or efficiency can be given.  
Made with Metropix ©2024

