





11 Chapel Court, King's Lynn PE30 1EG

£115,000

 2  1  1

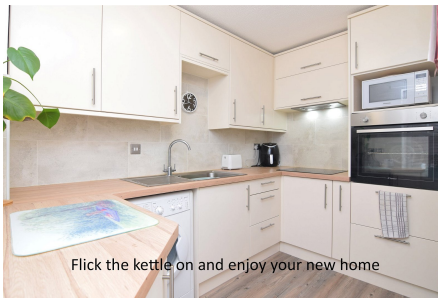

Turn the key, put the kettle on and relax.... Nestled in the town centre, this ground floor, over 55's apartment offers you the opportunity to move straight in, it's delightful presentation and location make it a perfect home or weekend getaway.





Key Features

- Ground Floor Apartment
- Two Bedrooms
- Superb Town Centre Location
- Abundance of Amenities on your Doorstep
- No Onward Chain
- Stunning Presentation - Recently Renovated
- Over 55s Accommodation
- Council Tax Band A
- Modern Electric Heating System
- Ideal For Town Centre Living

GROUND FLOOR
529 sq.ft. (49.2 sq.m.) approx.

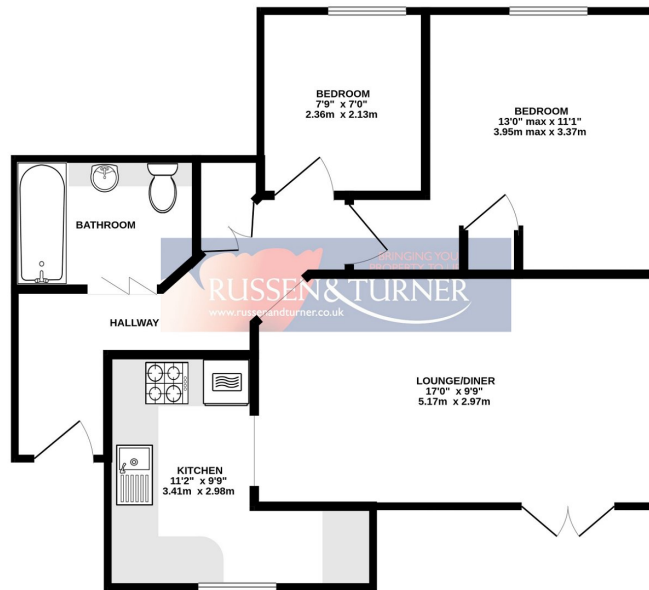

TOTAL FLOOR AREA: 529 sq.ft. (49.2 sq.m.) approx.
 Whilst every attempt has been made to ensure the accuracy of the floorplan contained herein, measurements of doors, windows, rooms and any other items are approximate and no responsibility is taken for any error, omission or mis-statement. This plan is for illustrative purposes only and should be used as such by any prospective purchaser. The services, systems and appliances shown have not been tested and no guarantee as to their operation or efficiency can be given.
 Made with Metropix ©2024

