



47 Higham Green, King's Lynn PE30 4RY

£180,000

3 1 1



NO ONWARD CHAIN! A bright and airy, mid-terrace home that is ready for you to make your own. This, plus the fact it is close to the Queen Elizabeth Hospital, what more could you want from a first home or investment property.





Key Features

- Mid Terraced House
- Three Bedrooms
- Generous 25ft Reception Room
- No Onward Chain
- Sought After Location - Close to QE Hospital
- Gas Central Heating
- Enclosed Low Maintenance Rear Garden
- Ideal First Home
- Council Tax Band - A
- Potential Investment Opportunity

GROUND FLOOR
485 sq.ft. (45.1 sq.m.) approx.

1ST FLOOR
447 sq.ft. (41.5 sq.m.) approx.

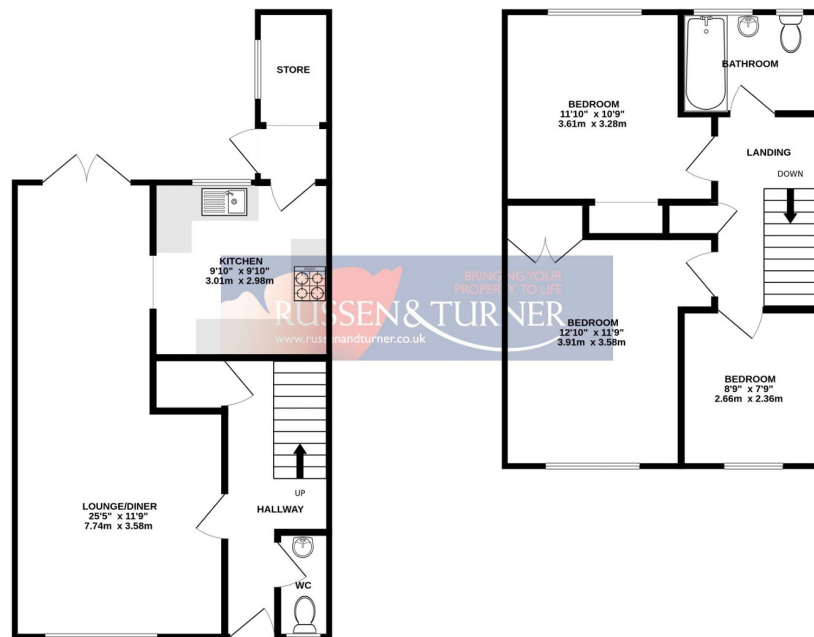

TOTAL FLOOR AREA: 932 sq. ft. (86.6 sq.m.) approx.

Whilst every attempt has been made to ensure the accuracy of the floorplan contained here, measurements of doors, windows, rooms and any other items are approximate and no responsibility is taken for any error, omission or mis-statement. This plan is for illustrative purposes only and should be used as such by any prospective purchaser. The services, systems and appliances shown have not been tested and no guarantee as to their operability or efficiency can be given.

Made with Metropix ©2023

