





## 2 Mill Road, Terrington St John PE14 7SF

Offers Over £200,000

 3  1  1



**MAKE THIS HOME YOUR OWN!** Nestled in the heart of the village, a short walk from the wide variety of local amenities is this generously proportioned, detached bungalow. Boasting huge potential, the property is ready for you to put your stamp on it and turn it into your dream property.





## Key Features

- Detached Bungalow
- No Onward Chain
- Electric Underfloor Heating
- Garage and Off-road Parking
- Kitchen/Breakfast Room
- Three Double Bedrooms
- Rural Village Setting
- Close to Village Amenities
- Huge Potential to Improve
- Make this Home your Own

GROUND FLOOR  
1041 sq.ft. (96.7 sq.m.) approx.

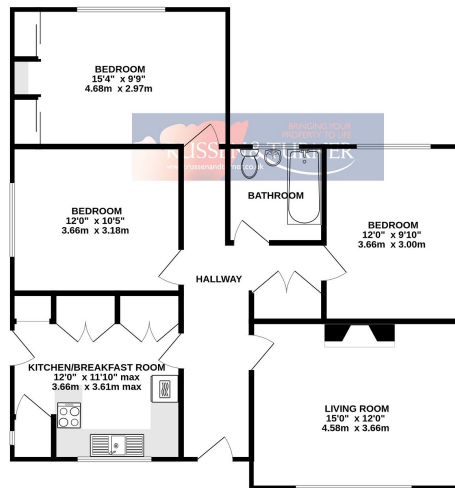
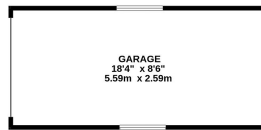

TOTAL FLOOR AREA: 1041 sq.ft. (96.7 sq.m.) approx.

Whilst every attempt has been made to ensure the accuracy of the description contained here, measurements of doors, windows, rooms and any other items are approximate and no responsibility is taken for any error, omission or mis-statement. This plan is for illustrative purposes only and should be used as such by any prospective purchaser. The services, systems and appliances shown have not been tested and no guarantee is given as to their operability or efficiency capabilities.  
Made with Metropac C2023

