



## 39 Westmark, King's Lynn PE30 4RG

£179,995

3 1 2



**NO ONWARD CHAIN!** A well presented, bright and airy, end of terrace home that is ready to be moved straight into. All of this plus the fact it is close to the Queen Elizabeth Hospital, what more could you want from a first home or investment property.





## Key Features

- End of Terrace House
- Two Reception Rooms
- Enclosed Rear Garden with Good Privacy
- Sought After Location - Close to QE Hospital
- Ideal First Home
- Three Bedrooms
- No Onward Chain
- Gas Central Heating
- Well Presented
- Council Tax Band - A

GROUND FLOOR  
481 sq.ft. (44.7 sq.m.) approx.

1ST FLOOR  
446 sq.ft. (41.5 sq.m.) approx.

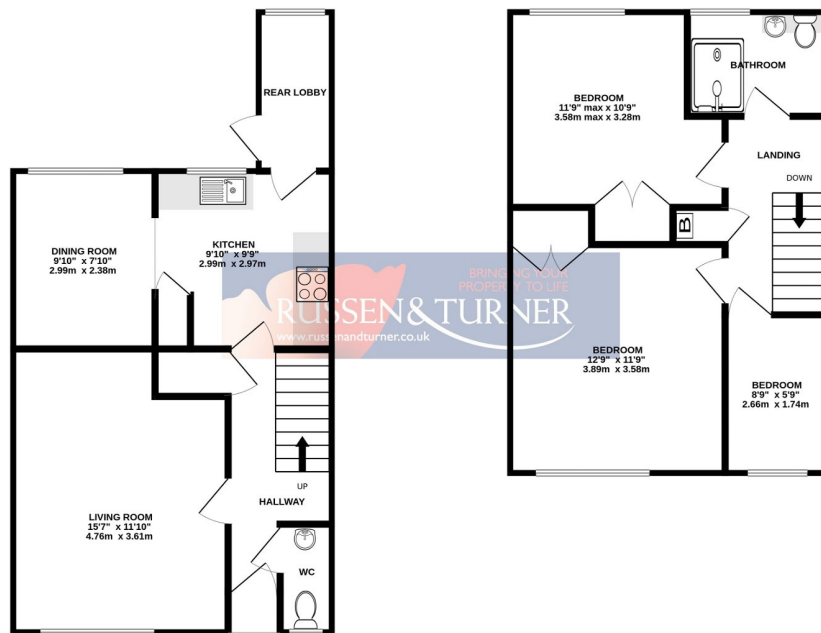

TOTAL FLOOR AREA - 928 sq.ft. (86.2 sq.m.) approx.

Whilst every attempt has been made to ensure the accuracy of the floorplan contained here, measurements of doors, windows, rooms and any other items are approximate and no responsibility is taken for any error, omission or mis-statement. This plan is for illustrative purposes only and should be used as such by any prospective purchaser. The services, systems and appliances shown have not been tested and no guarantee as to their operability or efficiency can be given.

Made with Metropix i2022

