



## 18 King George V Avenue, King's Lynn PE30 2QF

£328,000

3 1 2



Imagine family gatherings in this sizable, 23ft, bay-fronted lounge with the log-burner on in the winter and the French doors open in the summer. A fabulous family home which could easily be converted to a 4 bedroom home and is located less than a mile from the town centre with ample parking for all the family to the front and rear of the house.





## Key Features

- Semi-detached house
- 2 Reception rooms
- Ample private parking
- 20ft Principal bedroom
- Ground floor W.C
- 3 Double bedrooms
- Refurbished by current owners
- 23ft Lounge
- Utility
- Less than a mile from town

GROUND FLOOR  
677 sq.ft. (62.9 sq.m.) approx.

1ST FLOOR  
577 sq.ft. (53.6 sq.m.) approx.

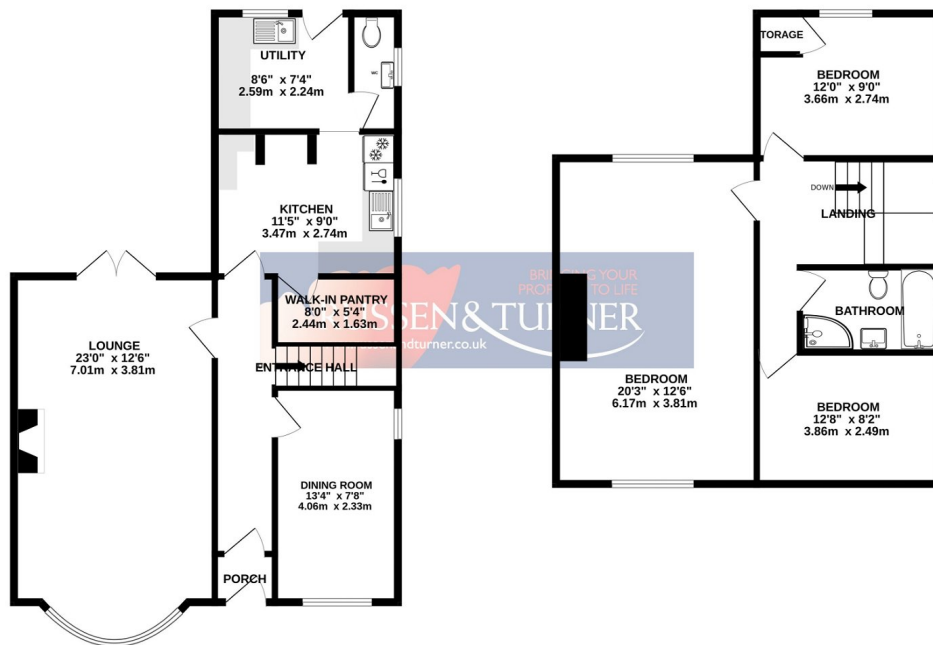

TOTAL FLOOR AREA : 1254 sq.ft. (116.5 sq.m.) approx.

Whilst every attempt has been made to ensure the accuracy of the floorplan contained here, measurements of doors, windows, rooms and any other items are approximate and no responsibility is taken for any error, omission or mis-statement. This plan is for illustrative purposes only and should be used as such by any prospective purchaser. The services, systems and appliances shown have not been tested and no guarantee as to their operability or efficiency can be given.  
Made with Metropix ©2023

