



## 25 Gloucester Road, King's Lynn PE30 4AB

£269,995

3 1 2



Looking for property in the popular Newlyn area? Like the idea of living on a cul-de-sac and having a generous sized garden? Take a look at this semi-detached house which could well tick all your boxes.





## Key Features

- Semi-detached house
- 2 Reception rooms
- Garage
- Generous plot
- Cul-de-sac
- 3 Bedrooms
- Extended kitchen
- Private parking
- Gas central heating
- Sought after location

GROUND FLOOR  
572 sq.ft. (53.2 sq.m.) approx.

1ST FLOOR  
398 sq.ft. (36.9 sq.m.) approx.

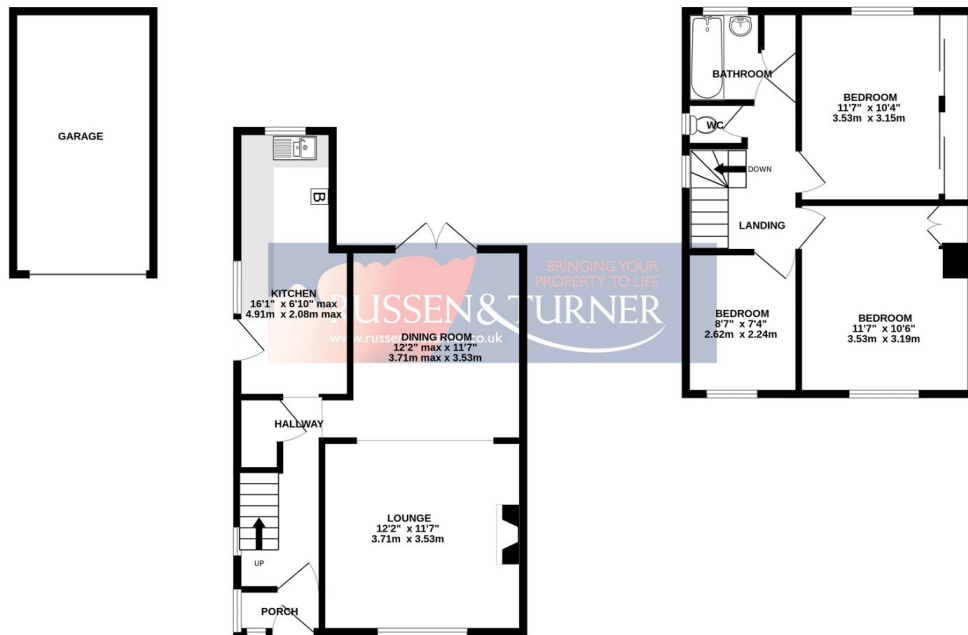

TOTAL FLOOR AREA: 970 sq.ft. (90.1 sq.m.) approx.

Whilst every attempt has been made to ensure the accuracy of the floorplan contained here, measurements of doors, windows, rooms and any other items are approximate and no responsibility is taken for any error, omission or mis-statement. This plan is for illustrative purposes only and should be used as such by any prospective purchaser. The services, systems and appliances shown have not been tested and no guarantee as to their operability or efficiency can be given.  
Made with Metropix ©2023

