



2 Orchard Court, King's Lynn PE30 4BL

£110,000

2 1 1



Communal gardens overlooking Gaywood River and beyond



NO ONWARD CHAIN! A fantastic opportunity to secure a generously sized apartment found just off the ever popular Wootton Road. Overlooking the communal gardens and Gaywood River behind, the property offers gas central heating and double glazing along with the opportunity to make the property your own.





Key Features

- Ground Floor Apartment
- Bright and Airy Living Room
- Gas Central Heating
- First Home or Potential Investment Opportunity
- Council Tax Band - A
- Two Bedrooms
- Views over Communal Gardens and Gaywood River
- No Onward Chain
- Communal Parking Area
- Set just off Wootton Road

GROUND FLOOR
623 sq.ft. (57.9 sq.m.) approx.

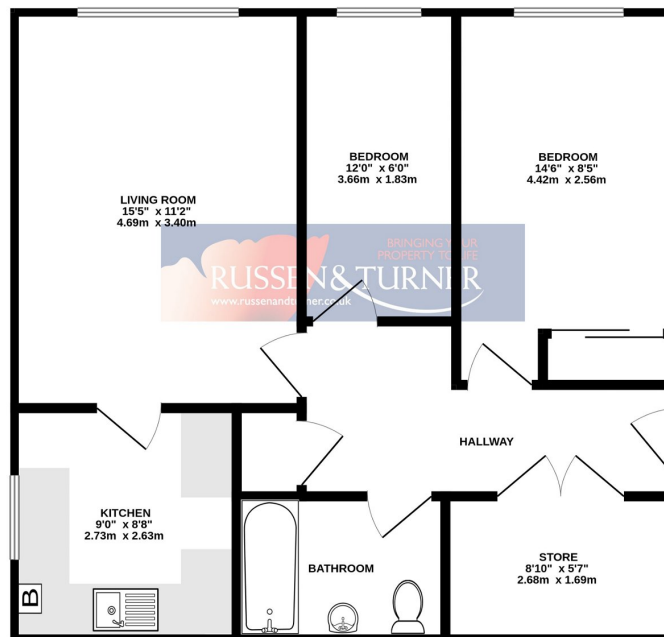

TOTAL FLOOR AREA - 623 sq.ft. (57.9 sq.m.) approx.

Whilst every attempt has been made to ensure the accuracy of the floorplan contained here, measurements of doors, windows, stairs and any other items are approximate and no responsibility is taken for any error, omission or mis-statement. This plan is for illustrative purposes only and should be used as such by any prospective purchaser. The services, systems and appliances shown have not been tested and no guarantee as to their operability or efficiency can be given.
Made with Metropix 12/21

