





1 Hall Farm Barns, Middleton PE32 1RW

£470,000

 3  2  2



A location that will take your breath away! Nestled among trees and with stunning views that change with the seasons, this wonderfully presented property impresses at every turn. Escape from the stresses and strains of modern day living with the peace and tranquillity this home offers.





Key Features

- Bungalow
- Stunning Rural Setting
- Underfloor Heating
- Beautifully Presented
- Breathtaking Views
- Three Double Bedrooms
- Nestled Among Mature Trees and Grass Meadows
- Garage and Off-road Parking
- Fantastic Kitchen/Dining Room
- Check out the Video Tour

GROUND FLOOR
1298 sq.ft. (120.6 sq.m.) approx.

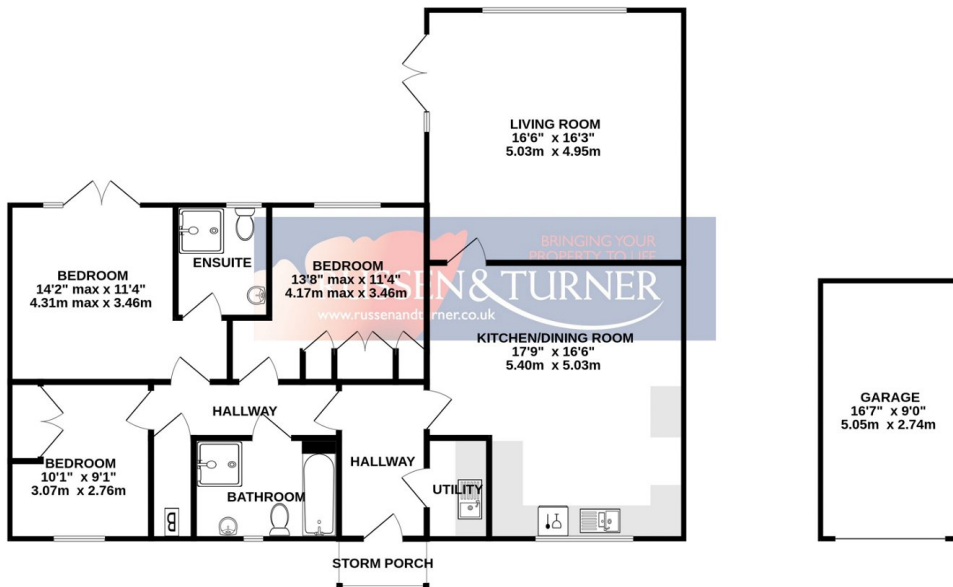

TOTAL FLOOR AREA : 1298 sq.ft. (120.6 sq.m.) approx.

Whilst every attempt has been made to ensure the accuracy of the floorplan contained here, measurements of doors, windows, rooms and any other items are approximate and no responsibility is taken for any error, omission or mis-statement. This plan is for illustrative purposes only and should be used as such by any prospective purchaser. The services, systems and appliances shown have not been tested and no guarantee as to their operability or efficiency can be given.
Made with Metropix ©2023

