



## 57 Castle Rising Road, South Wootton PE30 3JA

£455,000

3 2 2



**Fancy being tucked away down a nice, private lane with plenty of space for family and friends?** This fantastic family home is set just off the salubrious Castle Rising Road in South Wootton and is set within a superb garden measuring approximately a quarter of an acre (sts) so ample space for a game of football with the children.





## Key Features

- Desirable address
- Solar panels (fitted 2023)
- Video Tour
- 2 Bathrooms
- Approx. quarter acre plot (sts)
- Non-estate
- Ample parking
- Open plan living kitchen
- 3 Double bedrooms
- Detached bungalow

GROUND FLOOR  
1359 sq.ft. (126.2 sq.m.) approx.

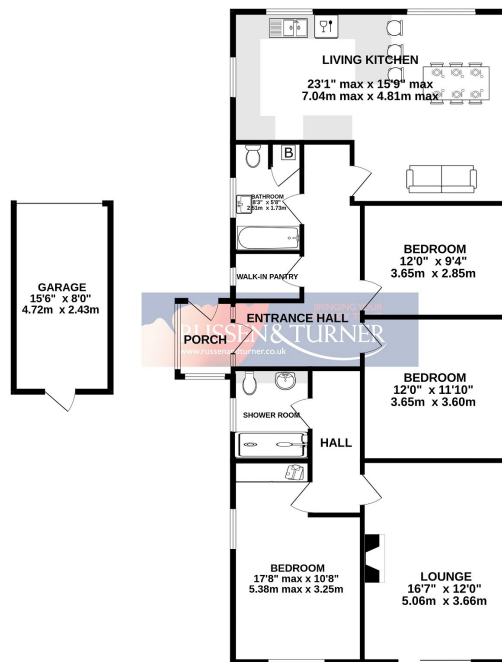

TOTAL FLOOR AREA: 1359 sq.ft. (126.2 sq.m.) approx.  
 Whilst every attempt has been made to ensure the accuracy of the floorplan contained here, measurements of doors, windows, rooms and any other items are approximate and no responsibility is taken for any error, omission or mis-statement. This plan is for illustrative purposes only and should be used as such by any prospective purchaser. The services, systems and appliances shown have not been tested and no guarantee as to their operability or efficiency can be given.  
 Made with Metropix 02023

