



Bellfosters, King's Lynn

£275,000

3 2 2



A rare opportunity to acquire this unique, Grade II listed, town house located within the beautiful, historic quarter of King's Lynn and just a 'stones throw' from the River Gt. Ouse. The property, which offers versatile accommodation, is leasehold and is set over 3 floors and has access to a cellar.





Key Features

- Two/Three Bedrooms
- Grade II Listed
- Two En-suites
- Town Centre - Perfect Location
- Share of Freehold
- One/Two Reception Rooms
- Stunning location - Quay Front on your doorstep
- No Onward Chain
- Historic Quarter of King's Lynn
- Superb Character and Space

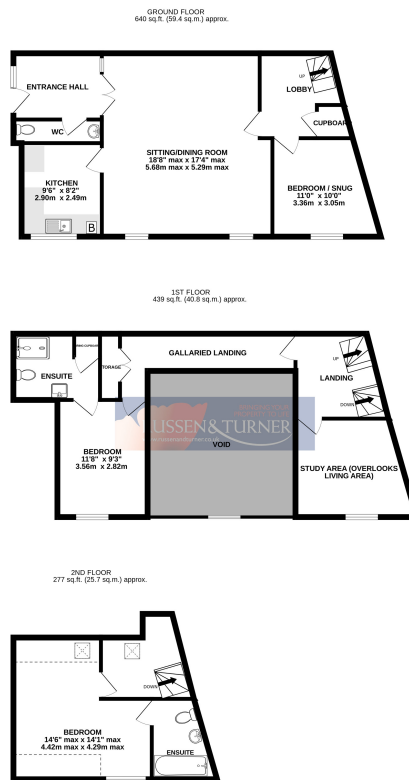

TOTAL FLOOR AREA: 1355 sq.ft. (125.9 sq.m.) approx.

Whilst every attempt has been made to ensure the accuracy of the floorplan contained here, measurements of doors, windows, rooms and any other items are approximate and no responsibility is taken for any error, omission or mis-statement. This plan is for illustrative purposes only and should be used as such by any prospective purchaser. The services, systems and appliances shown have not been tested and no guarantee as to their quality or efficiency can be given.
Made with Metropix (2023)

