



## 19 Robertson Way, Sapley, Huntingdon, PE28 2GG

- Mid terraced home
- Two double bedrooms
- West facing rear garden
- Garage to rear
- Close to Cinema and restaurants
- Tesco Extra and shopping facilities nearby

## Full Description

A spacious two bedroom mid terraced home in a popular area in Sapley close to Cinema, restaurants, playing fields and out of town shopping facilities including Tesco Extra. The accommodation comprises; entrance hall, WC, kitchen and living room on the ground floor. The first floor has two double bedrooms and a bathroom. Externally, there is a West facing rear garden plus a garage to the rear. The property benefits from UPVC windows and gas radiator heating. Viewing highly recommended! No forward chain.

### ENTRANCE HALL

Entrance door leading to entrance hall. Stairs to first floor. Radiator. Door to WC, kitchen and living room.

### WC

Two piece white suite comprising low level WC and pedestal wash hand basin. Tiled splash backs. Radiator. UPVC window to front.

### KITCHEN

10' 0" x 5' 9" (3.05m x 1.75m)

Fitted kitchen comprising work surfaces with complimentary drawers and cupboards under. Wall mounted cupboards. Single bowl sink with mixer tap and tiled splash backs. Built in electric oven and four ring hob with extractor over. Space for fridge / freezer. Plumbing for washing machine. Wall mounted gas boiler. UPVC window to front.

### LIVING / DINING ROOM

14' 9" x 12' 8" (4.5m x 3.86m)

UPVC sliding doors to rear garden. TV and telephone point. Radiator. Wood flooring.

### LANDING

Doors to bedrooms and bathroom. Loft access.

### BEDROOM ONE

12' 8" x 9' 3" (3.86m x 2.82m)

UPVC window to rear. Radiator.

### BEDROOM TWO

9' 6" x 8' 7" (2.9m x 2.62m)

UPVC window to front. Built in wardrobe. Radiator.

### BATHROOM

Three piece suite comprising low level WC, pedestal wash hand basin and panelled bath with shower over. Tiled splash backs and glass screen. Heated towel rail. Extractor fan.



## REAR GARDEN

West facing rear garden mainly laid to lawn with patio area.  
Gated access to rear.

## GARAGE

Single garage accessed to rear below coach house.



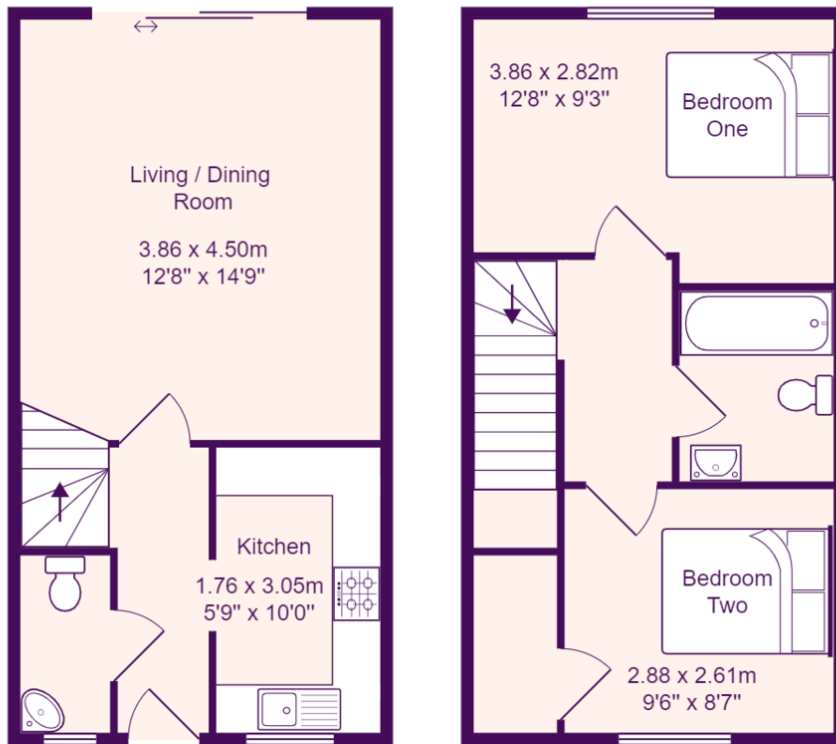

**Ground Floor**

**First Floor**

Total Area: 58.9 m<sup>2</sup> ... 634 ft<sup>2</sup>

All measurements are approximate and for display purposes only

EPC GRAPH  
%epcGraph\_c\_1\_150%