



29 Ferrars Avenue, Eynesbury, St. Neots, PE19 2TZ

- Semi-Detached family home
- Three good sized bedrooms
- Very well presented throughout
- Off road parking for several vehicles
- Open plan living space
- Refitted kitchen and bathroom

Full Description

This stunning 1920s three bedroom semi-detached family home is located in the popular old Eynesbury area. The property is within short walking distance to local schools, shops and amenities as well as easy access to the A1 and A428. The accommodation comprises entrance hall, utility room, open plan kitchen/dining area and lounge on the ground floor. The first floor has three good sized bedrooms and a family bathroom and separate WC. There are UPVC windows and doors throughout and a gas radiator central heating. Externally there is a generous private rear garden with a fully provisioned summerhouse and a driveway with space for four cars to the front.

ENTRANCE HALL

Double glazed composite door to side and UPVC door to rear. Radiator. Wood effect kardean flooring. Stairwell and under stairs storage. Doors leading to utility room and kitchen area.

UTILITY ROOM

6' 8" x 5' 0" (2.03m x 1.52m)

Plumbing for washing machine, Combi gas boiler, storage units.

KITCHEN AREA

10' 9" x 7' 9" (3.28m x 2.36m)

Refitted kitchen comprising of work surfaces with drawers and cupboards under. Wall mounted cupboards. One and half bowl black composite sink/drainer with mixer tap. Electric induction hob with extractor unit over. Integrated fridge/freezer. Microwave oven. Electric multifunctional oven. integrated dishwasher. UPVC windows to front and side. Tiled floor. Recessed downlights.

DINING ROOM AREA

14' 10" x 10' 9" (4.52m x 3.28m)

UPVC double glazed window to front. Wood effect kardean flooring. Radiator. Exposed ceiling beams and recessed downlights. Open feature fire place.

LIVING AREA

10' 9" x 9' 8" (3.28m x 2.95m)

UPVC French doors to rear. Wood effect kardean flooring. Radiator. Exposed ceiling beams and recessed downlights.

LANDING

UPVC windows to rear. Airing cupboard. Storage cupboard. Loft access



WC

Low level WC. UPVC window to rear. Tiled floor

BATHROOM

Comprising of vanity wash hand basin and panelled bath with shower over. Mixer taps and hand shower. Partially tiled walls. Tiled floor. Chrome towel radiator. UPVC window to side.

BEDROOM ONE

14' 5" x 10' 9" (4.39m x 3.28m)

UPVC window to front. Fitted wardrobes and draws. Recessed downlights. Radiator. Carpeted floor.

BEDROOM TWO

11' 5" x 9' 8" (3.48m x 2.95m)

UPVC window to rear. Radiator. Carpeted floor

BEDROOM THREE

10' 9" x 8' 2" (3.28m x 2.49m)

UPVC window to front. Radiator. Carpeted floor

DRIVEWAY

Gravelled drive way with parking for 4 vehicles. Shared pathway.

REAR GARDEN

Timber fence enclosed rear garden, mainly laid to lawn with raised flower beds and patio seating area immediately to the rear of the property. A decked seating area and summerhouse complete with air-conditioning, power and lighting has been constructed at the bottom of the garden.



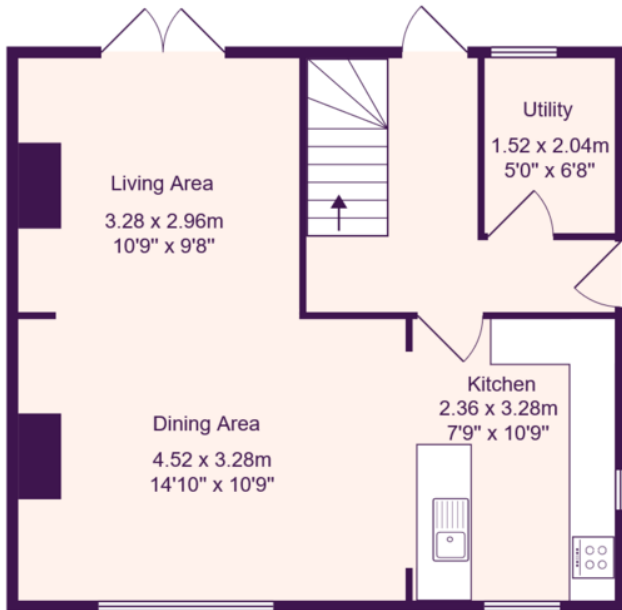

Ground Floor

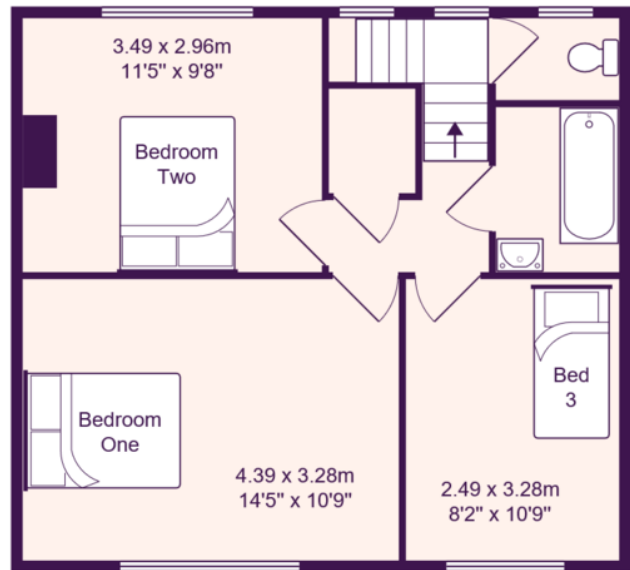

First Floor

Total Area: 87.9 m² ... 946 ft²

All measurements are approximate and for display purposes only