



**LOVETT**  
Sales & Lettings

£275,000



## 6 Swallowfield, Wyboston, Bedford, MK44 3AE

- Semi-detached Bungalow
- Two bedrooms
- Village location
- Conservatory
- Off road parking to side
- Enclosed rear garden

# Full Description

## ENTRANCE HALL

UPVC entrance door leading to entrance hall. Electric heater. Airing cupboard. Doors to living room, bedrooms and bathroom. Loft access.

## LIVING / DINING ROOM

17' 3" x 11' 7" (5.26m x 3.53m)

UPVC window to rear. Window to hallway. TV and telephone point. Electric heater. Door to conservatory. Archway through to kitchen.



## KITCHEN

6' 8" x 8' 5" (2.03m x 2.57m)

Fitted kitchen comprising work surfaces with complimentary drawers and cupboards under. Wall mounted cupboards. One and a half bowl sink with mixer tap and tiled splash backs. Built in electric oven and four ring gas hob (Calor gas bottles) with extractor over. Plumbing for washing machine. Tiled floor. UPVC windows to rear.



## CONSERVATORY

9' 0" x 7' 5" (2.74m x 2.26m)

UPVC conservatory with door to side. Electric heater.

## BEDROOM ONE

12' 4" x 11' 9" (3.76m x 3.58m)

UPVC Bay window to front.

## BEDROOM TWO

11' 9" x 7' 8" (3.58m x 2.34m)

UPVC window to front and side. Wood flooring.



## BATHROOM

Three piece suite comprising low level WC, pedestal wash hand basin and panelled bath with shower over. Tiled splash backs. Heated towel rail. Extractor fan. UPVC window to side.

## REAR GARDEN

Enclosed rear garden mainly laid to paving. Gated access to side. Storage shed.

## PARKING

Parking space to the side of the property.





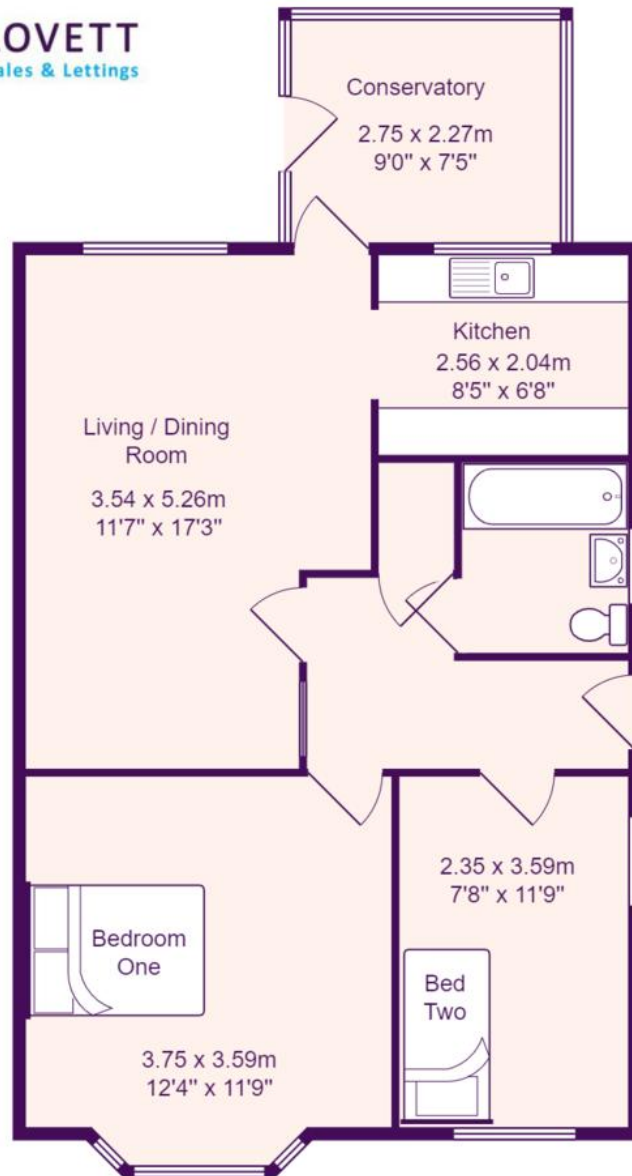

Total Area: 62.5 m<sup>2</sup> ... 672 ft<sup>2</sup>

All measurements are approximate and for display purposes only