

# *Callaghans*

Independent Estate Agents, Surveyors, Valuers and Mortgage Brokers

## **Flat 8, The Whitehouse,** **Handforth, SK9 3BD**



### **Offers in the Region Of**

**£100,000**

**A Spacious Two Bedroom First Floor Apartment**

**Situated in a Converted Church**

**Open Plan Kitchen/Living/Dining Room**

**Two Double Bedrooms**

**Shower Room**

**Off-Road Parking**

**Well Maintained Communal Areas**

Callaghans Estate Agents

46 Church Road, Gatley, SK8 4NQ

Telephone: 0161 491 4000, Fax: 0161 491 55 44

Website: [www.callaghansltd.com](http://www.callaghansltd.com) Email: [admin@callaghansltd.com](mailto:admin@callaghansltd.com)

A spacious two bedroom first floor apartment situated in a converted church. In brief the property comprises: private entrance hall with storage cupboard, open plan kitchen/living/dining room, two double bedrooms, shower room, an off-road parking space and well maintained communal areas.

From our office in Gatley, turn right onto Church Road. Turn left onto Styal Road. Turn left onto the A555. Take the exit towards Wilmslow Road. At the roundabout take the third exit onto Wilmslow Road. At the second roundabout take the first exit onto Wilmslow Road where The Whitehouse can be found on the left hand side.

**Entrance Hall** Wooden front door, a double glazed window and storage cupboard.

**Kitchen/Living/Dining Room** 28' 10" x 14' 10" (8.78m x 4.52m) (Maximum)

**Living Room** A double glazed window, double radiator and television point.

**Kitchen/Dining Area** A range of wall & base units with contrasting worktops, tiled splash back, integrated oven, four ring electric hob with extractor hood above, one & a half bowl sink with drainer, two double glazed windows and a double radiator.

**Bedroom One** 15' 5" x 9' 1" (4.70m x 2.77m) Two double glazed windows and a double radiator.

**Bedroom Two** 11' 2" x 9' 1" (3.40m x 2.77m) A double glazed window and a double radiator.

**Shower Room** 6' 9" x 5' 7" (2.06m x 1.70m) Shower cubicle, low level WC, wash hand basin, heated towel rail, extractor fan and part tiled walls.

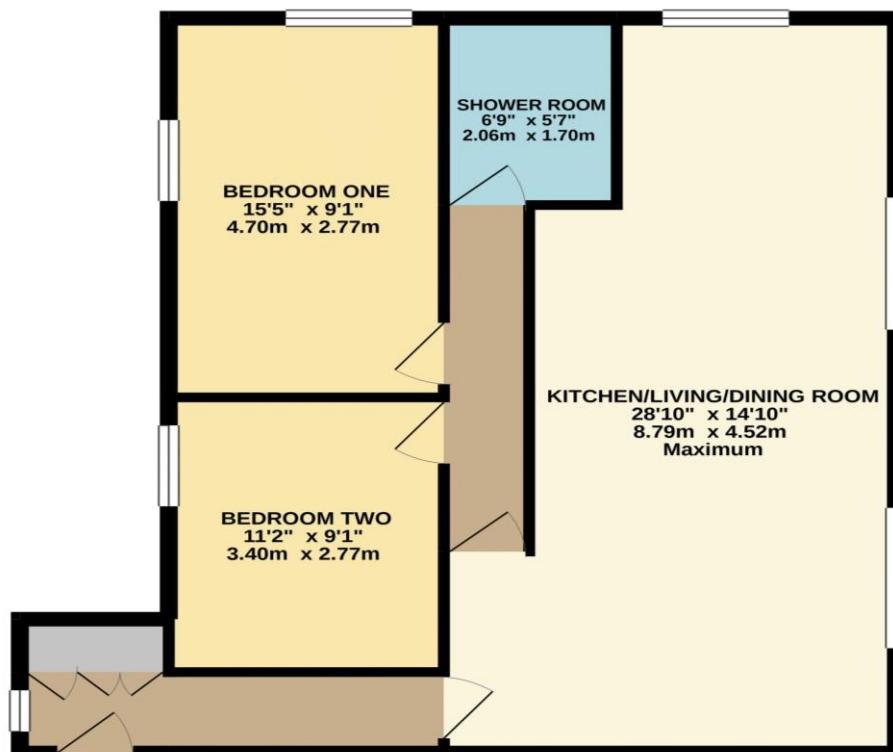

Whilst every attempt has been made to ensure the accuracy of the floorplan contained here, measurements of doors, windows, rooms and any other items are approximate and no responsibility is taken for any error, omission or mis-statement. This plan is for illustrative purposes only and should be used as such by any prospective purchaser. The services, systems and appliances shown have not been tested and no guarantee as to their operability or efficiency can be given.  
Made with Metropix ©2021.

**Disclaimer:**

These particulars, whilst believed to be accurate are set out as a general guideline only or guidance and do not constitute any part of an offer or contract. Intending purchasers should not rely on them as statements of representation or fact, but must satisfy themselves by inspection or otherwise as to their accuracy. Please note that we have not tested any apparatus, equipment, fixtures, fittings or services, including gas central heating and so cannot verify they are in working order or fit for their purpose. Further more solicitors should confirm movable items described in the sales particulars are, in fact included in the sale since circumstances do change during marketing or negotiations. Although we try to ensure accuracy, measurements used in this brochure may be approximate. Therefore if intending purchasers need accurate measurements to order carpeting or to ensure existing furniture will fit, they should take such measurements themselves. **YOUR HOME IS AT RISK IF YOU DO NOT KEEP UP REPAYMENTS ON A MORTGAGE OR OTHER LOAN SECURED ON IT**