

# *Callaghans*

Independent Estate Agents, Surveyors, Valuers and Mortgage Brokers

**52 Tennyson Road,**  
**Cheadle, SK8 2AR**



**£325,000**

**Stylish Semi-Detached  
Two Double Bedrooms  
Modern Kitchen  
Rear Garden  
Off Road Parking  
Freehold**

Callaghans Estate Agents  
46 Church Road, Gatley, SK8 4NQ  
Telephone: 0161 491 4000, Fax: 0161 491 55 44  
Website: [www.callaghansltd.com](http://www.callaghansltd.com) Email: [admin@callaghansltd.com](mailto:admin@callaghansltd.com)

Callaghans are pleased to offer for sale this charming two-bedroom semi-detached home in Cheadle, boasting a spacious landscaped rear garden and off-road parking. Beautifully presented and finished to a high specification, this property combines style, comfort, and an excellent location, making it an ideal choice for a range of buyers.

The accommodation begins with a bright and inviting lounge featuring a bay window to the front and patio doors to the rear, opening directly onto the garden. At the heart of the home is a stunning kitchen, thoughtfully designed with an array of wall and base units, a central peninsula breakfast bar, and skylights that flood the space with natural light — creating a perfect spot for cooking, dining, and entertaining.

Upstairs, there are two generously sized double bedrooms and a contemporary family bathroom with a modern suite and over-bath shower.

Externally, the property enjoys a beautifully landscaped rear garden, ideal for relaxing or entertaining, and a driveway providing convenient off-road parking.

With its high-quality finish, versatile living spaces, and sought-after location, this property is expected to attract strong interest. **Book your viewing with Callaghans today.**

**Lounge** 16' 5" x 11' 1" (5m x 3.39m)

**Kitchen/Diner** 14' 9" x 13' 6" (4.5m x 4.12m)

**Family Bathroom** 7' 2" x 6' 2" (2.19m x 1.89m)

**Bedroom One** 15' 11" x 9' 10" (4.85m x 3m)

**Bedroom Two** 9' 1" x 11' 3" (2.78m x 3.42m)

GROUND FLOOR  
399 sq.ft. (37.0 sq.m.) approx.



1ST FLOOR  
301 sq.ft. (28.0 sq.m.) approx.

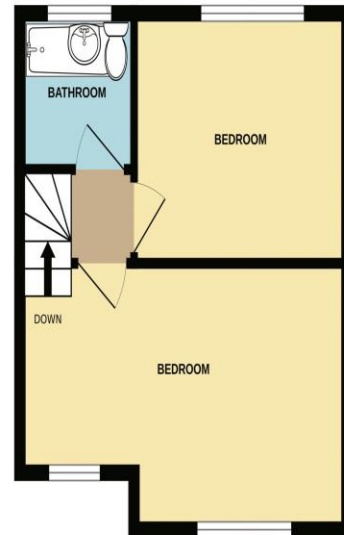

TOTAL FLOOR AREA: 700 sq.ft. (65.0 sq.m.) approx.

Whilst every attempt has been made to ensure the accuracy of the floorplan contained here, measurements of doors, windows, rooms and any other items are approximate and no responsibility is taken for any error, omission or mis-statement. This plan is for illustrative purposes only and should be used as such by any prospective purchaser. The services, systems and appliances shown have not been tested and no guarantee as to their operability or efficiency can be given.  
Made with Metropix ©2025

**Disclaimer:**

These particulars, whilst believed to be accurate are set out as a general guideline only or guidance and do not constitute any part of an offer or contract. Intending purchasers should not rely on them as statements of representation or fact, but must satisfy themselves by inspection or otherwise as to their accuracy. Please note that we have not tested any apparatus, equipment, fixtures, fittings or services, including gas central heating and so cannot verify they are in working order or fit for their purpose. Further more solicitors should confirm movable items described in the sales particulars are, in fact included in the sale since circumstances do change during marketing or negotiations. Although we try to ensure accuracy, measurements used in this brochure may be approximate. Therefore if intending purchasers need accurate measurements to order carpeting or to ensure existing furniture will fit, they should take such measurements themselves. **YOUR HOME IS AT RISK IF YOU DO NOT KEEP UP REPAYMENTS ON A MORTGAGE OR OTHER LOAN SECURED ON IT**