

# *Callaghans*

Independent Estate Agents, Surveyors, Valuers and Mortgage Brokers

**3 Parkwood Road,**  
**Manchester, M23 0AA**



**£250,000**

**Period Semi-Detached  
Three Bedrooms  
Original Features  
Modern Bathroom  
Front and Rear Gardens  
Garage and Drive**

Callaghans Estate Agents  
46 Church Road, Gatley, SK8 4NQ  
Telephone: 0161 491 4000, Fax: 0161 491 55 44  
Website: [www.callaghansltd.com](http://www.callaghansltd.com) Email: [admin@callaghansltd.com](mailto:admin@callaghansltd.com)

**Callaghans are pleased to offer for sale this attractive semi-detached property with scope to improve it to your tastes. The property has plenty of original style and features, enhanced by a new bathroom. The welcoming hallway gives access to the dining kitchen with modern units and patio doors into the garden. The lounge is the length of the property with windows and door at the end opening into the sunroom and garden. On the first floor are three good sized bedrooms and the tiled bathroom with modern suite and over bath shower. Externally there is a garage and outhouse for storage as well as mature gardens. This could well be your stylish forever home for your family to grow into.**

**Lounge 11' 10" x 19' 7" (3.61m x 5.97m)**

**Kitchen/Diner 7' 3" x 16' 9" (2.22m x 5.10m)**

**Family Bathroom 7' 9" x 5' 10" (2.37m x 1.77m)**

**Bedroom One 9' 9" x 11' 11" (2.96m x 3.63m)**

**Bedroom Two**

**Bedroom Three 7' 4" x 6' 7" (2.24m x 2m)**

GROUND FLOOR  
481 sq.ft. (44.6 sq.m.) approx.

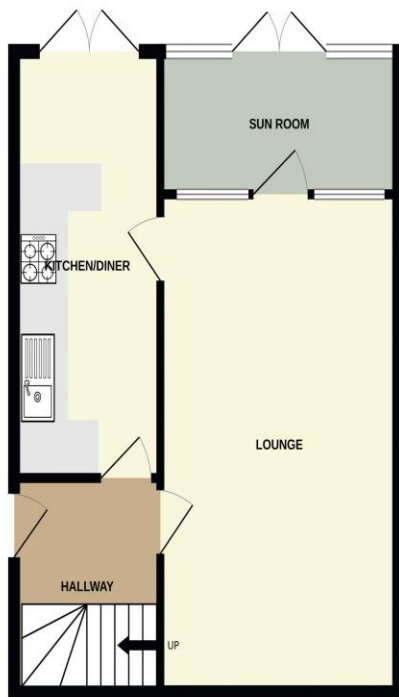

1ST FLOOR  
384 sq.ft. (35.6 sq.m.) approx.

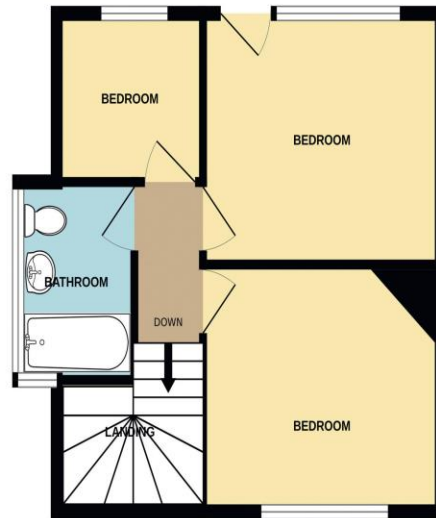

TOTAL FLOOR AREA : 864 sq.ft. (80.3 sq.m.) approx.

Whilst every attempt has been made to ensure the accuracy of the floorplan contained here, measurements of doors, windows, rooms and any other items are approximate and no responsibility is taken for any error, omission or mis-statement. This plan is for illustrative purposes only and should be used as such by any prospective purchaser. The services, systems and appliances shown have not been tested and no guarantee as to their operability or efficiency can be given.  
Made with Metropix 6/2024

#### Disclaimer:

These particulars, whilst believed to be accurate are set out as a general guideline only or guidance and do not constitute any part of an offer or contract. Intending purchasers should not rely on them as statements of representation or fact, but must satisfy themselves by inspection or otherwise as to their accuracy. Please note that we have not tested any apparatus, equipment, fixtures, fittings or services, including gas central heating and so cannot verify they are in working order or fit for their purpose. Further more solicitors should confirm movable items described in the sales particulars are, in fact included in the sale since circumstances do change during marketing or negotiations. Although we try to ensure accuracy, measurements used in this brochure may be approximate. Therefore if intending purchasers need accurate measurements to order carpeting or to ensure existing furniture will fit, they should take such measurements themselves. **YOUR HOME IS AT RISK IF YOU DO NOT KEEP UP REPAYMENTS ON A MORTGAGE OR OTHER LOAN SECURED ON IT**