

Callaghans

Independent Estate Agents, Surveyors, Valuers and Mortgage Brokers

15 Viscount Drive,
Cheadle, SK8 3HU



£285,000

**Three Bedroom Detached
Conservatory
White Gloss Kitchen
Fitted Wardrobes
Front and Rear Gardens
Off Road Parking**

Callaghans Estate Agents
46 Church Road, Gatley, SK8 4NQ
Telephone: 0161 491 4000, Fax: 0161 491 55 44
Website: www.callaghansltd.com Email: admin@callaghansltd.com

Callaghans are pleased to offer for sale this charming three bedroom detached property on the edge of Heald Green Close to the airport by-pass, giving excellent transport links. The property is on a small modern estate of similar properties. The lounge is to the front of the property with a bay window lighting the way, through a arch is the dining area, leading into the white gloss kitchen with an array of floor and wall units. At the rear is the spacious conservatory, nestled in the landscaped garden. The side driveway has ample room for a couple of cars. On the first floor is the white tiled bathroom with modern suite and over bath shower. The three bedrooms are proportional and have fitted wardrobes. Given the location and style of this property we expect a lot of interest, book your viewing now.

Lounge 11' 9" x 12' 6" (3.57m x 3.8m)

Dining area 7' 7" x 7' 10" (2.32m x 2.4m)

Kitchen 7' 2" x 8' 6" (2.18m x 2.6m)

Conservatory 10' 8" x 9' 10" (3.25m x 3m)

Family Bathroom 5' 7" x 6' 5" (1.7m x 1.95m)

Bedroom One 8' 6" x 10' 2" (2.6m x 3.1m)

Bedroom Two 8' 10" x 10' 6" (2.68m x 3.2m)

Bedroom Three 7' 4" x 6' 6" (2.24m x 1.97m)

GROUND FLOOR
430 sq.ft. (39.9 sq.m.) approx.



1ST FLOOR
319 sq.ft. (29.6 sq.m.) approx.

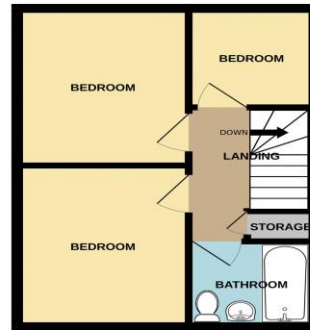

TOTAL FLOOR AREA: 749 sq.ft. (69.6 sq.m.) approx.

Whilst every attempt has been made to ensure the accuracy of the floorplan contained here, measurements of areas, volumes, rooms and any other items are approximate and no responsibility is taken for any error or omission in the information. This plan is for illustrative purposes only and should be used as a guide only. Prospective purchasers should confirm measurements and verify the accuracy of the information. The services, systems and appliances shown have not been tested and no guarantee is given for their operation or efficiency over time.
Made with Metropack ©2024

Disclaimer:

These particulars, whilst believed to be accurate are set out as a general guideline only or guidance and do not constitute any part of an offer or contract. Intending purchasers should not rely on them as statements of representation or fact, but must satisfy themselves by inspection or otherwise as to their accuracy. Please note that we have not tested any apparatus, equipment, fixtures, fittings or services, including gas central heating and so cannot verify they are in working order or fit for their purpose. Further more solicitors should confirm movable items described in the sales particulars are, in fact included in the sale since circumstances do change during marketing or negotiations. Although we try to ensure accuracy, measurements used in this brochure may be approximate. Therefore if intending purchasers need accurate measurements to order carpeting or to ensure existing furniture will fit, they should take such measurements themselves. **YOUR HOME IS AT RISK IF YOU DO NOT KEEP UP REPAYMENTS ON A MORTGAGE OR OTHER LOAN SECURED ON IT**