

Callaghans

Independent Estate Agents, Surveyors, Valuers and Mortgage Brokers

16 Fairhaven Street,
Manchester, M12 5EE



£160,000

**New Renovation
Two Bedrooms
Great First Home
New Kitchen
Move in Condition
Close to Central Manchester**

Callaghans Estate Agents
46 Church Road, Gatley, SK8 4NQ
Telephone: 0161 491 4000, Fax: 0161 491 55 44
Website: www.callaghansltd.com Email: admin@callaghansltd.com

Callaghans are pleased to offer for sale, this newly renovated two-bedroom terraced house that promises comfort and convenience. The property is offered without a chain and is ready for you to move into. This particular property boasts a spacious lounge, perfect for family gatherings or a cozy evening in. The heart of the home is the modern grey kitchen, fully fitted and designed to cater to your culinary needs. Upstairs, the two double bedrooms offer ample space for rest and relaxation, while the family bathroom is well-appointed with a shower over the bath, ensuring functionality meets style. Notably, the house is equipped with gas central heating and double glazing, providing a warm and energy-efficient environment. The added benefit of on-street parking makes this an ideal home for those seeking easy access to Manchester's vibrant city centre. With such features, this property is not just a house, but a place to call home. Contact Callaghans to find out how you could be moving in.

Lounge 14' 1" x 11' 0" (4.28m x 3.36m)

Kitchen 9' 7" x 11' 0" (2.92m x 3.36m)

Bathroom 5' 0" x 6' 11" (1.52m x 2.10m)

Bedroom One

Bedroom Two 8' 1" x 7' 5" (2.47m x 2.25m)

**Callaghans Estate Agents
46 Church Road, Gatley, SK8 4NQ
Telephone: 0161 491 4000, Fax: 0161 491 55 44
Website: www.callaghansltd.com Email: admin@callaghansltd.com**

GROUND FLOOR
267 sq.ft. (24.8 sq.m.) approx.

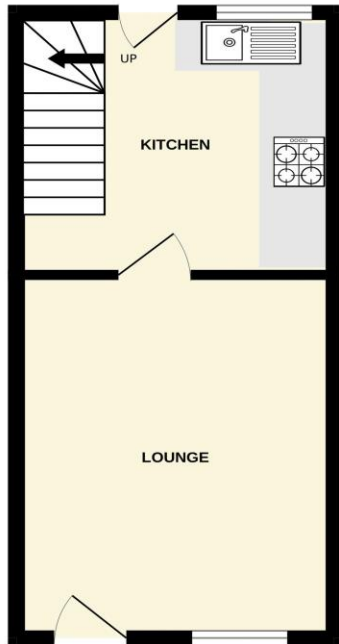

1ST FLOOR
267 sq.ft. (24.8 sq.m.) approx.

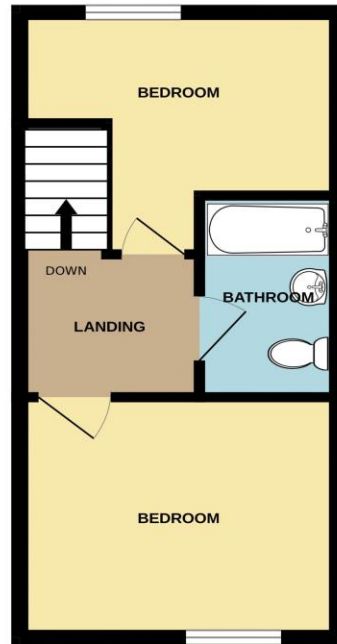

TOTAL FLOOR AREA: 534 sq.ft. (49.6 sq.m.) approx.

Whilst every attempt has been made to ensure the accuracy of the floorplan contained here, measurements of doors, windows, rooms and any other items are approximate and no responsibility is taken for any error, omission or mis-measurement. This plan is for illustrative purposes only and should be used as such by any prospective purchaser. The services, systems and appliances shown have not been tested and no guarantee as to their operability or efficiency can be given.

Made with Metropix ©2024

Disclaimer:

These particulars, whilst believed to be accurate are set out as a general guideline only or guidance and do not constitute any part of an offer or contract. Intending purchasers should not rely on them as statements of representation or fact, but must satisfy themselves by inspection or otherwise as to their accuracy. Please note that we have not tested any apparatus, equipment, fixtures, fittings or services, including gas central heating and so cannot verify they are in working order or fit for their purpose. Further more solicitors should confirm movable items described in the sales particulars are, in fact included in the sale since circumstances do change during marketing or negotiations. Although we try to ensure accuracy, measurements used in this brochure may be approximate. Therefore if intending purchasers need accurate measurements to order carpeting or to ensure existing furniture will fit, they should take such measurements themselves. **YOUR HOME IS AT RISK IF YOU DO NOT KEEP UP REPAYMENTS ON A MORTGAGE OR OTHER LOAN SECURED ON IT**