

Callaghans

Independent Estate Agents, Surveyors, Valuers and Mortgage Brokers

Apartment 63 Victoria Mill, **Stockport,SK5 6AR**



£850pcm

Loft Style Apartment
One Double Bedroom
Modern Bathroom
Open Plan Living
Communal Parking
Communal Gym
Deposit £980.77

Callaghans Estate Agents
46 Church Road, Gatley, SK8 4NQ
Telephone: 0161 491 4000, Fax: 0161 491 55 44
Website: www.callaghansltd.com Email: admin@callaghansltd.com

An exceptional one-bedroom apartment is now available for rent in the stunning Victoria Mill. This unfurnished property boasts original architectural features, including exposed beams and brickwork, which add a touch of historical charm. The spacious open-plan living area is complemented by a large mill window that floods the space with natural light, and a sleek white kitchen that offers modern convenience. A contemporary tiled bathroom features a modern suite complete with an over-bath shower. The double bedroom is practical and stylish, with fitted wardrobes providing ample storage. Residents will benefit from secure parking and access to a private gym, enhancing the appeal of this desirable location. Given the high demand for such unique properties, prompt viewing is strongly advised to avoid missing out on this rare opportunity.

Lounge 20' 2" x 9' 7" (6.14m x 2.91m)

Kitchen 7' 10" x 12' 3" (2.4m x 3.73m)

Bathroom 5' 7" x 7' 10" (1.69m x 2.38m)

Bedroom 9' 1" x 12' 4" (2.78m x 3.76m)

**Callaghans Estate Agents
46 Church Road, Gatley, SK8 4NQ
Telephone: 0161 491 4000, Fax: 0161 491 55 44
Website: www.callaghansltd.com Email: admin@callaghansltd.com**

GROUND FLOOR
449 sq.ft. (41.7 sq.m.) approx.

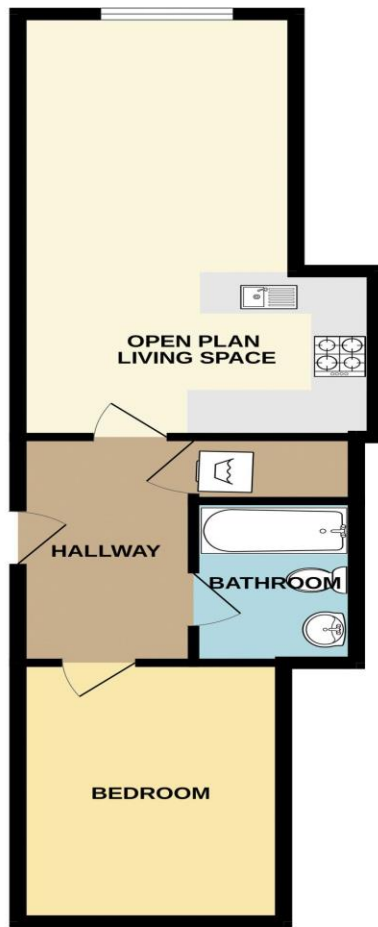

sq.m.) approx.
or plan contained here, measurements
to responsibility is taken for any error,
and should be used as such by any
ave not been tested and no guarantee
e given.

Disclaimer:

These particulars, whilst believed to be accurate are set out as a general guideline only or guidance and do not constitute any part of an offer or contract. Intending purchasers should not rely on them as statements of representation or fact, but must satisfy themselves by inspection or otherwise as to their accuracy. Please note that we have not tested any apparatus, equipment, fixtures, fittings or services, including gas central heating and so cannot verify they are in working order or fit for their purpose. Further more solicitors should confirm movable items described in the sales particulars are, in fact included in the sale since circumstances do change during marketing or negotiations. Although we try to ensure accuracy, measurements used in this brochure may be approximate. Therefore if intending purchasers need accurate measurements to order carpeting or to ensure existing furniture will fit, they should take such measurements themselves. **YOUR HOME IS AT RISK IF YOU DO NOT KEEP UP REPAYMENTS ON A MORTGAGE OR OTHER LOAN SECURED ON IT**