

Callaghans

Independent Estate Agents, Surveyors, Valuers and Mortgage Brokers

19 Bruntwood Avenue,
Heald Green, SK8 3RT



£369,950

**Extended Semi-Detached
Front and Rear Gardens.
Large Cream Gloss Kitchen
Three Bedrooms
Garage and Drive
Spacious Bathroom.
Freehold
Council Band D**

Callaghans Estate Agents
46 Church Road, Gatley, SK8 4NQ
Telephone: 0161 491 4000, Fax: 0161 491 55 44
Website: www.callaghansltd.com Email: admin@callaghansltd.com

Callaghans are happy to present this opportunity to own a stunning semi-detached home in Heald Green, with plenty of space and style. This property boasts a cream gloss kitchen that will impress any guest, with a curved breakfast bar and a lovely view of the garden. The hallway is inviting and has a convenient downstairs toilet. The lounge is bright and spacious, with a patio door that leads to a beautiful patio and garden area, perfect for relaxing or entertaining. Upstairs, you will find three generous double bedrooms, two with fitted wardrobes, and a family bathroom with modern suite with over bath shower. The garage has an up and over door and the drive can fit two cars, plus there is a small lawn at the front. The property is situated on a quiet street off Style Road, in a desirable location. This could be the dream home you've been looking for. Call Callaghans today to arrange a viewing.

Lounge 24' 2" x 11' 2" (7.36m x 3.4m)

Kitchen/Breakfast Room 17' 5" x 11' 10" (5.31m x 3.6m)

Downstairs Toilet 5' 1" x 3' 8" (1.56m x 1.13m)

Bedroom One 13' 5" x 11' 3" (4.08m x 3.44m)

Bedroom Two 10' 8" x 10' 4" (3.26m x 3.15m)

Bedroom Three 9' 11" x 8' 5" (3.03m x 2.56m)

Family Bathroom 8' 4" x 7' 4" (2.55m x 2.23m)

Callaghans Estate Agents
46 Church Road, Gatley, SK8 4NQ
Telephone: 0161 491 4000, Fax: 0161 491 55 44
Website: www.callaghansltd.com Email: admin@callaghansltd.com

GROUND FLOOR
570 sq.ft. (52.9 sq.m.) approx.



1ST FLOOR
452 sq.ft. (42.0 sq.m.) approx.

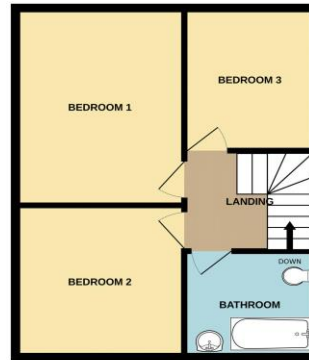

TOTAL FLOOR AREA: 1022 sq.ft. (95.0 sq.m.) approx.

Whilst every attempt has been made to ensure the accuracy of the floorplan contained herein, measurements of doors, windows, rooms and any other items are approximate and no responsibility is taken for any error, omission or mis-statement. This plan is for illustrative purposes only and should be used as such by any prospective purchaser. The services, systems and appliances shown have not been tested and no guarantee as to their operability or efficiency can be given.
Made with Metropack ©2024

Disclaimer:

These particulars, whilst believed to be accurate are set out as a general guideline only or guidance and do not constitute any part of an offer or contract. Intending purchasers should not rely on them as statements of representation or fact, but must satisfy themselves by inspection or otherwise as to their accuracy. Please note that we have not tested any apparatus, equipment, fixtures, fittings or services, including gas central heating and so cannot verify they are in working order or fit for their purpose. Further more solicitors should confirm movable items described in the sales particulars are, in fact included in the sale since circumstances do change during marketing or negotiations. Although we try to ensure accuracy, measurements used in this brochure may be approximate. Therefore if intending purchasers need accurate measurements to order carpeting or to ensure existing furniture will fit, they should take such measurements themselves. **YOUR HOME IS AT RISK IF YOU DO NOT KEEP UP REPAYMENTS ON A MORTGAGE OR OTHER LOAN SECURED ON IT**