



MAURICE KILBRIDE

RESIDENTIAL SALES & LETTING AGENTS

✉ sales@mkiea.co.uk 🌐 www.mkiea.co.uk ☎ 0161 428 3663

81 Aber Road, Cheadle, SK8 2ER

Offers Over £315,000

🛏 3 🚿 1 🚗 1



This much improved and extended bay fronted semi-detached family home, is on the sought-after Boundary Estate. Perfectly positioned for families, this stylish three-bedroom property is close to excellent schools, shops, and offers easy access to the national motorway network, ideal for commuters. Inside, you'll find a porch, hall, a light-filled through living room. The heart of the home is the stunning contemporary kitchen/dining room, featuring a range of integrated appliances. upstairs is an attractive bathroom/WC. Other benefits include gas central heating and double glazing. Outside, there is a good sized, private lawned rear garden with multiple seating areas, offering a nice space for outdoor living. There is an attached garage and off-road parking to the front. Viewing highly recommended.

Key Features

- Prime Boundary estate location
- Three bedrooms
- Stylish contemporary fitted dining kitchen
- Good size private lawned rear garden
- Close to shops, popular schools and motorway access
- Extended and improved family home
- Bay fronted through living room
- Gas central heating and double glazing
- Attached garage and off road parking
- Viewing highly recommended

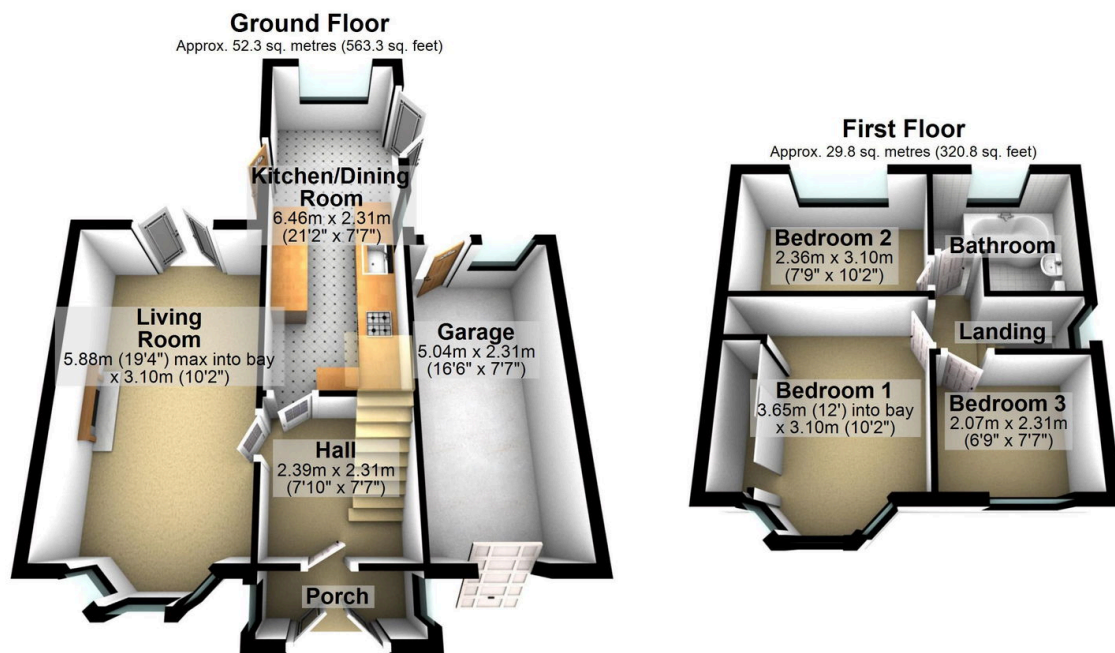

Total area: approx. 82.1 sq. metres (884.1 sq. feet)