



Spinneyfield, Moorgate

£1,250.00pcm Deposit: £1,442.00



Available To Let! Be quick to book your viewing for this beautifully presented THREE Bedroom semi-detached home, currently undergoing refurbishment***. In brief, the accommodation comprises: Lounge * Separate Dining Room * BRAND NEW Fitted Kitchen with Built-In Oven and Hob * Side Extension Conservatory with rear access and leading into Garage* Family Bathroom with Bath and Shower Over * TWO Double Bedrooms * ONE Single Bedroom* Outside offers a driveway providing parking for MULTIPLE cars, while to the rear, you'll find a generous lawned garden and paved area. Rent: £1,250.00 / Deposit: £1,442.00 / Council Tax: C / EPC: D / Holding deposit and references required. Bartons belong to the client money protection scheme Property Mark the scheme reference number is C0008413

www.bartons-net.co.uk



ACCOMMODATION

- THREE Bedroom Semi Detached Home
- Currently undergoing refurbishment works***
- NEWLY fitted Kitchen with built in Oven & Hob
- Off street parking for MULTIPLE cars
- Sought after Location
- Holding Deposit & References required
- Council Tax: C
- Available to Let- enquiry now!

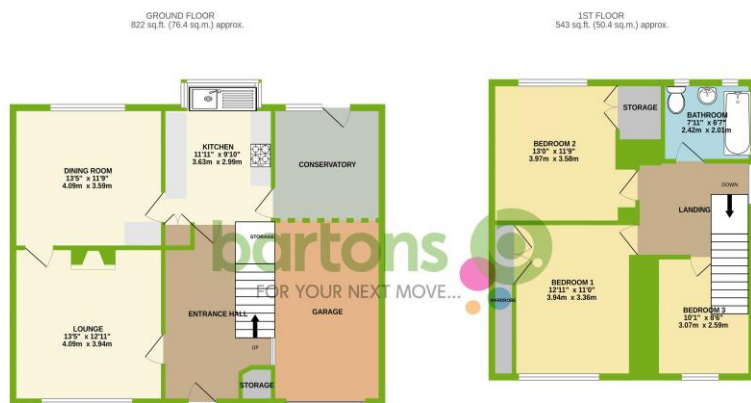

TOTAL FLOOR AREA: 1365 sq.ft. (126.8 sq.m.) approx.

Whilst every attempt has been made to ensure the accuracy of the floorplans contained herein, measurements of doors, windows, rooms and any other items are approximate and no responsibility is taken for any error, omission or misstatement. This plan is for illustrative purposes only and should be used as such by any prospective purchaser. The services, systems and appliances shown have not been tested and no guarantee as to their operability or efficiency can be given.

Made with Metagame ©2025

bartons

FOR YOUR NEXT MOVE...

51-53 Moorgate Street, Rotherham, South Yorkshire, S60 2EY
T: 01709 515740 E: info@bartons-net.co.uk

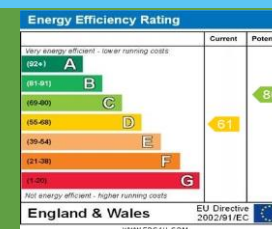

Important Notice These particulars are issued in good faith but do not constitute representations of fact or form part of any contract. These particulars should be independently verified by prospective buyers or tenants. Neither Barton Real Estates Ltd nor any of its employees or agents has any authority to make or give any representation or warranty whatsoever in relation to this property. Any areas of measurement or distances are approximate. Please note that we have not tested the services or any of the equipment in this property, accordingly we strongly advise prospective buyers to commission their own survey or service reports before finalising their offer to purchase. Printed by Facefirst Ltd 01670 713330