



Woodland Way, HERRINGTHORPE



Guide Price £185,000 to £190,000 - This appealing three bedroom semi-detached property is priced to reflect the need for general updating but gives prospective buyers the budget to buy and create their very own ideal home. It is located within a much sought after residential location, has a woodland backdrop, and is handy for commuting, shops at Parkgate, local amenities at the Stag and of course well regarded Schools making it a PERFECT FAMILY PURCHASE. Accommodation Comprises: Entrance Hall, Lounge, Dining Room, Kitchen, Lean to Conservatory, three Bedrooms, modern Shower Room and separate WC. Externally it comes with its own driveway leading to a DETACHED GARAGE and there are Gardens to the front and rear, the rear with a feature fishpond and water feature. Viewing by Appointment - Call 01700 515740

www.bartons-net.co.uk



ACCOMMODATION

- Three Bedroom Semi-Detached Family Home
- GREAT OPPORTUNITY TO CREATE YOUR IDEAL HOME
- Competitively Priced to Reflect the Need for a General Update
- Pleasant Wood Side Location, Handy for Shops, Transport Links and Reputable Schools
- Two Reception Rooms, Kitchen, Lean To Conservatory
- Modern Shower Room and Separate WC
- Gardens front and Rear, DETACHED GARAGE
- **** Viewing by Appointment ONLY ****



GROUND FLOOR:
526 sq.ft. (48.9 sq.m.) approx.

1ST FLOOR:
427 sq.ft. (39.7 sq.m.) approx.

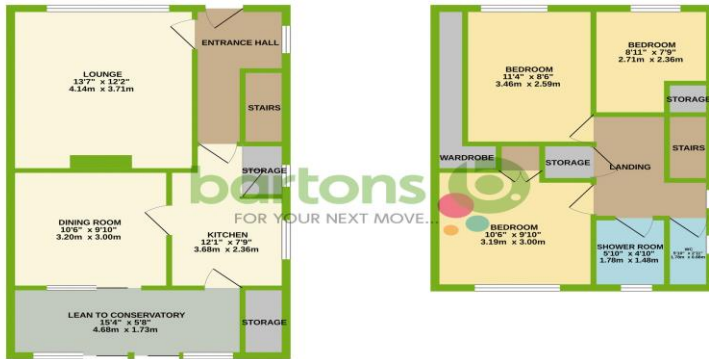

bartons
FOR YOUR NEXT MOVE...

TOTAL FLOOR AREA: 953 sq.ft. (88.5 sq.m.) approx.

Whilst every attempt has been made to ensure the accuracy of the 'Properties' contained herein, measurements of areas, volumes, rooms and any other items are approximate and no responsibility is taken for any error. Bartons Real Estate Limited does not warrant the accuracy of the information provided. The plan is for illustrative purposes only and should not be used for any other purpose. The services, systems and appliances shown have not been tested and no guarantee can be given for their operation or efficiency. Please see the agent for more information.



bartons
FOR YOUR NEXT MOVE...

51-53 Moorgate Street, Rotherham, South Yorkshire, S60 2EY
T: 01709 515740 E: info@bartons-net.co.uk

Important Notice These particulars are issued in good faith but do not constitute representations of fact or form part of any contract. These particulars should be independently verified by prospective buyers or tenants. Neither Barton Real Estate nor its agents accept any representation or warranty whatsoever in relation to this property. Any areas of measurement or distances are approximate. Please note that we have not tested the services or any of the equipment in this property, accordingly we strongly advise prospective buyers to commission their own survey or service reports before finalising their offer to purchase. Printed by Bartons Net Ltd 01709 515740