



Limesway, Maltby



This tastefully appointed rear extended three bedroom semi-detached is located within an in-demand residential area of Maltby close to shopping, schools, transport links and doctors surgery making this AN IDEAL FAMILY PURCHASE. It has an additional and most generous extended sitting room, with centre French doors looking into the garden, has a bay windowed Lounge, an OPEN PLAN Kitchen Diner - both with multi-fuel burning stoves, the Kitchen with built-in cooking appliances. It also has a useful downstairs Shower / Wet Room, three ample first floor bedrooms and a family bathroom. Externally it doesn't disappoint having gardens to the front and rear, the front with a spacious driveway and mixed borders, the rear being privately enclosed with a GARDEN STORE and a garden which is laid to lawn.

**Asking Price £250,000**

[www.bartons-net.co.uk](http://www.bartons-net.co.uk)





## ACCOMMODATION

- Tastefully Appointed Three Bedroom Bat Windowed Semi-Detached
- Substantial rear EXTENSION - Sitting Room with Centre French Doors and useful Off-Shot Shower Room
- Bay Windowed Lounge with Multi-Fuel Burning Stove
- Attractive Lounge Diner with Further Stove
- SOUGHT AFTER LOCATION - Close to Schools, Shopping, Transport Links and Doctors Surgery
- **\*\* Ideal Family Purchase \*\*** Awaiting EPC

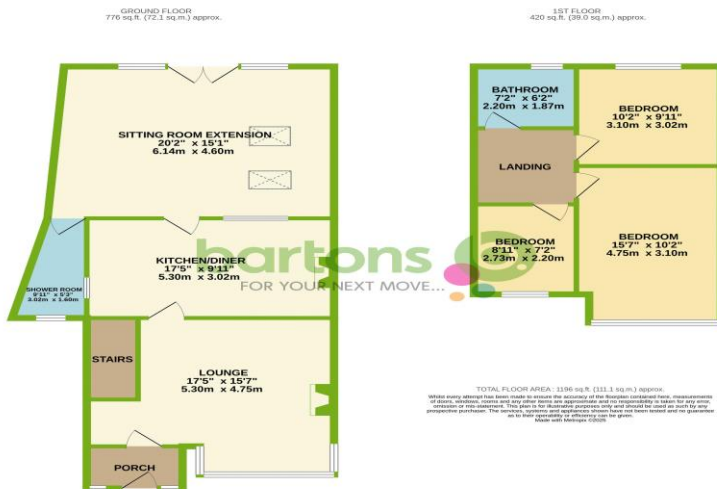

**bartons**   
FOR YOUR NEXT MOVE...

51-53 Moorgate Street, Rotherham, South Yorkshire, S60 2EY  
T: 01709 515740 E: [info@bartons-net.co.uk](mailto:info@bartons-net.co.uk)