



Barberwood Road, Blackburn



This well presented semi-detached home occupies a pleasant end of road position, having excellent commuter links for the M1, Sheffield and Rotherham Town Centre - with Blackburn Primary School and Meadowhall shopping centre within walking distance.

In brief the property comprises; Entrance Hall * Lounge * Dining Room * Kitchen with Integral Cooking Appliances * Three Bedrooms * Bathroom * Two Outbuildings (with electrics) Front Landscaped Low Maintenance Patio and Driveway * Rear Patio and Lawn Garden.

Offers in the region of: £149,950



www.bartons-net.co.uk



ACCOMMODATION

- Well Presented Semi-Detached Home - End of Road Position
- Two Reception Rooms, Modern Kitchen + Outbuildings
- Three Bedrooms & Modern Bathroom
- Driveway & Front Low Maintenance Garden & Patio
- Rear Lawn Garden & Patio
- Walking Distance to Blackburn Primary School
- Excellent Commuter Links for Sheffield, Meadowhall & The M1
- FREEHOLD / Council Tax Band A

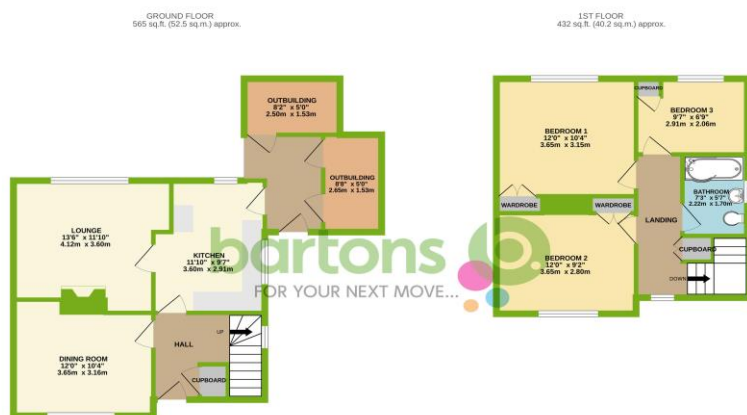

TOTAL FLOOR AREA: 997 sq.ft. (92.6 sq.m.) approx.

Whilst every attempt has been made to ensure the accuracy of the floorplan contained here, measurements of doors, windows, rooms and any other items are approximate and no responsibility is taken for any error, omission or mis-statement. This plan is for illustrative purposes only and should be used as such by any prospective purchaser. The services, systems and appliances shown have not been tested and no guarantee as to their operability or efficiency can be given.



51-53 Moorgate Street, Rotherham, South Yorkshire, S60 2EY

T: 01709 515740 E: info@bartons-net.co.uk