



Clifton Park View Apartments, Rotherham Town Centre



This NEW BUILD Beautifully Appointed and Spacious Apartment sits with a central location of the Town Centre, being upon the doorstep to a choice of shops, bars and restaurants with the bus and train station just a short walk. The property comes FURNISHED with new luxury furniture and in brief comprises; Secure Coded/Telecom Entry into the Communal Hall * Private Entrance Hall with Storage * Open Plan Spacious Living - Kitchen appointed with cooking appliances, full height fridge/freezer and washing machine * Three piece suite Bathroom with shower above bath.

** Deposit of £750.00 and References Required. Bartons belong to the client money protection scheme Property Mark, the scheme reference number is C0008413. Holding Deposit of £150.00

£650pcm



ACCOMMODATION

- NEW BUILD Spacious Studio Apartment
- First Floor - Beautifully Appointed Throughout
- Furnished with New Luxury Furniture
- Open Plan Living - Kitchen with Appliances
- Tiled Bathroom with Shower above Bath
- Secure Coded & Telecom Entry
- Central Rotherham Town Location - Close to Everything!
- AVAILABLE NOW! Holding Deposit, References & Bond Required

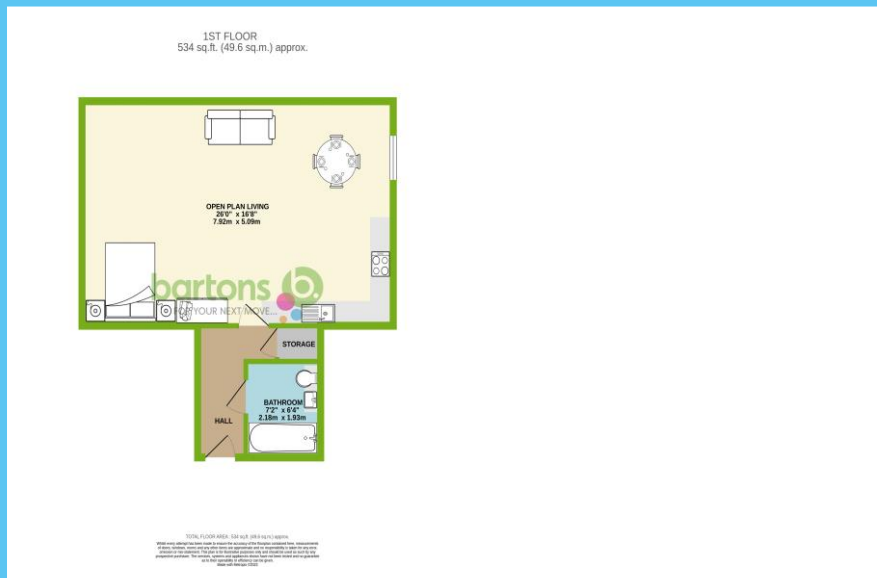

51-53 Moorgate Street, Rotherham, South Yorkshire, S60 2EY
T: 01709 515740 E: info@bartons-net.co.uk