



Wood Lane, Treeton



Guide Price £145,000 to £150,000 - The clue within the address, a larger built three double bedrooms ex-management home in the heart of Treeton Village with bus routes, schools and local amenities all on the doorstep. It has been fully refurbished with new fixtures and fittings throughout, accommodation comprising: Entrance Hallway with storage, two generous Reception Rooms, stylish newly fitted Kitchen with integral cooking appliances, a walk-in Pantry cupboard, two spacious first floor double bedrooms, a newly fitted Bathroom suite in white, and there is a further large double bedrooms to the second floor. Externally it comes with two outbuildings within a rear courtyard beyond which is a further garden area ready for occupation. VIEWING ADVISED.



ACCOMMODATION

- Larger Style Three Double Bedroom End Terrace
- Treeton Village with Bus Routes, Schools and Shops all Close By
- Spacious Lounge and Separate Dining Room
- Newly Fitted Kitchen and Bathroom
- Enviable Size with Lots of additional Storage Space
- Outbuildings, Courtyard and Additional Garden Area Beyond

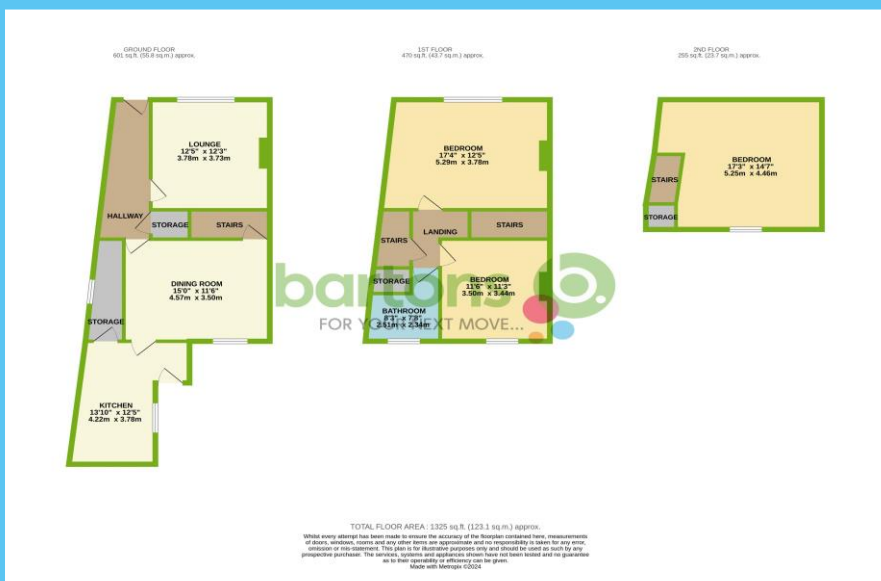

51-53 Moorgate Street, Rotherham, South Yorkshire, S60 2EY
 T: 01709 515740 E: info@bartons-net.co.uk



Important Notice These particulars are issued in good faith but do not constitute representations of fact or form part of any contract. These particulars should be independently verified by prospective buyers or tenants. Neither Barton Real Estates Ltd nor any of its employees or agents has any authority to make or give any representation or warranty whatsoever in relation to this property. Any areas of measurement or distances are approximate. Please note that we have not tested the services or any of the equipment in this property, accordingly we strongly advise prospective buyers to commission their own survey or service reports before finalising their offer to purchase. Printed by Facefirst Ltd 01670 713330