

**bartons**   
FOR YOUR NEXT MOVE...

Bridgewater Way, Ravenfield



This individually built three bedroom detached bungalow occupies a larger plot to the end of a lengthy private driveway, with field side views, in a highly regarded Ravenfield location. It provides generous living accommodation and is tastefully appointed throughout providing FAMILY LIVING ACCOMMODATION. A closer inspection of the floor plan reveals the opportunity for buyers to make more tailored changes with a POTENTIAL TO CONVERT THE GARAGE into additional living subject to planning approval. Current accommodation comprises: Entrance Hall with walk-in cloak cupboard, OPEN PLAN lounge Dining Room, fitted Kitchen with built-in cooking appliances, handy separate Utility Room and WC, Conservatory, three double bedrooms and an en-suite Shower Room, spacious Family Bathroom with Shower cubicle, sizeable integral DOUBLE GARAGE with electrically operated door with a 120 ft sq WORKSHOP at the rear which could easily be used as a HOME OFFICE. \*\* Viewing Advised - BY APPOINTMENT ONLY.

**Asking Price £430,000**

[www.bartons-net.co.uk](http://www.bartons-net.co.uk)





- Outstanding Individually Built DETACHED BUNGALOW
- Located to the end of a lengthy Private Driveway with Field Side Views
- Potentially to Convert Garage and Workshop into ADDITIONAL LIVING ACCOMMODATION
- OPEN PLAN Lounge Dining Room, Kitchen, Separate Utility and WC
- Conservatory, Three Double Bedrooms, En-Suite Shower Room and Spacious Family Bathroom
- Beautifully Kept Wrap around Gardens, with Patio Seating, ample Parking, Double Garage and Workshop
- Viewing by Appointment ONLY - EPC: to Follow



GROUND FLOOR  
1859 sq.ft. (172.7 sq.m.) approx.

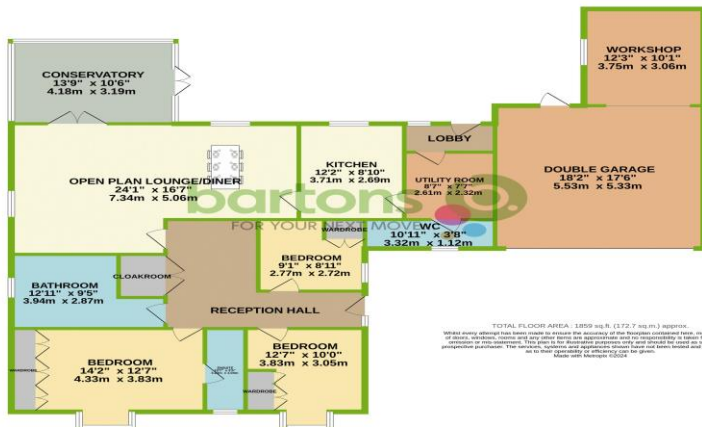

51-53 Moorgate Street, Rotherham, South Yorkshire, S60 2EY  
T: 01709 515740 E: info@bartons-net.co.uk

