

West View Road, Kimberworth



Offered for sale with NO ONWARD CHAIN is this Spacious and Well Presented Bungalow, being well positioned for Sheffield, Rotherham and the M1 Motorway links.

In brief the property comprises; Entrance Hall * Open Plan Lounge Diner with French Doors * Kitchen with Integral Appliances * Two Double Bedrooms with Fitted Wardrobes * Four Piece Suite Bathroom * Privately Enclosed West Facing Rear Patio and Lawn Garden * Front Low Maintenance Garden * Gated Driveway * Detached Garage and a Solid Built Shed, both with Electrics.

Offers in the region of: £220,000



ACCOMMODATION

- Double Bay Window Fronted Bungalow
- Well Presented & Spacious Throughout
- Two Double Bedrooms with Fitted Wardrobes / Four Piece Suite Bathroom
- Open Plan Lounge Diner with French Patio Doors
- Kitchen with Integral Appliances
- Combi Boiler Central Heating System
- Driveway, Garage & Shed - Both with Electrics.
- Rear Privately Enclosed Patio & Lawn Garden
- FREEHOLD / Council Tax Band B



GROUND FLOOR
710 sq.ft. (66.0 sq.m.) approx.

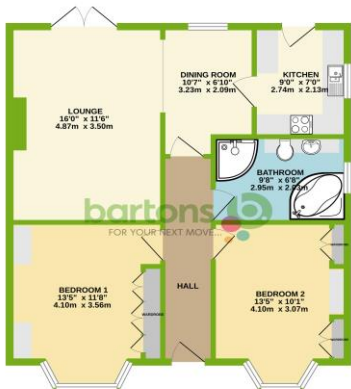

TOTAL FLOOR AREA: 710 sq.ft. (66.0 sq.m.) approx.

bartons **b.**
FOR YOUR NEXT MOVE...

51-53 Moorgate Street, Rotherham, South Yorkshire, S60 2EY

T: 01709 515740 E: info@bartons-net.co.uk